

SECOND

WORLD CONGRESS

ULTRASOUND IN MEDICAL EDUCATION

Conference & Schedule Program

September 27-29, 2013

Columbia Metropolitan
Convention Center

Columbia, South Carolina, USA



imagination at work

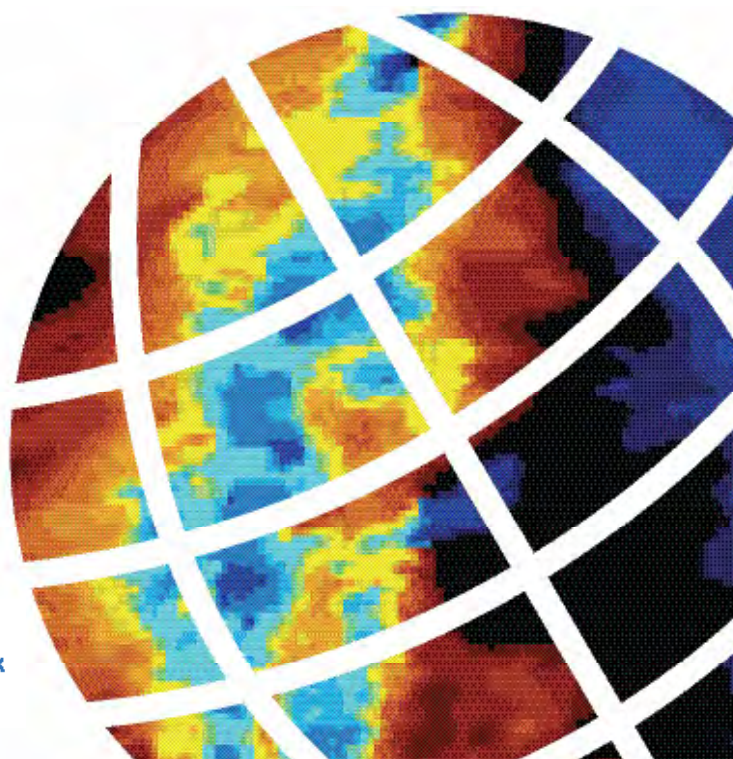

SECOND WORLD CONGRESS

ULTRASOUND IN MEDICAL EDUCATION

S E P T E M B E R 2 7 - 2 9, 2 0 1 3

Dear World Congress Attendee,

It is my pleasure to welcome you to Columbia, South Carolina and the Second World Congress on Ultrasound in Medical Education. This year's event offers you a unique opportunity to shape the future of medicine by influencing how we use ultrasound to teach and practice medicine.

At the Second World Congress, you will hear from internationally-recognized ultrasound experts who will introduce you to the latest advances in this ever-expanding field. Whether you are an experienced clinician or a novice, the hands-on training workshops will enhance your understanding of ultrasound and offer opportunities to improve your skills. You will have the opportunity to see the latest innovations in ultrasound technology and join the discussion of how best to incorporate ultrasound into medical education and clinical practice. The conference promises to expand your knowledge of ultrasound while creating networking opportunities with peers around the globe who share an interest in ultrasound and medical education.

In addition to the conference, I hope you take some time to enjoy the charm and southern hospitality of Columbia, South Carolina. The evening social events showcase two of the city's crown jewels of entertainment, the Columbia Museum of Art and the nationally-recognized Riverbanks Zoo.

I hope you can take advantage of the wonderful conference planned for you and that you find your experience to be educational and meaningful. Again, thank you for attending the Second World Congress and enjoy the hospitality of Columbia, South Carolina.



Richard A. Hoppmann, MD

President, Second World Congress on Ultrasound in Medical Education

Dean, University of South Carolina School of Medicine

ACCREDITATION

The University of South Carolina School of Medicine — Palmetto Health Continuing Medical Education Organization is accredited by the Accreditation Council for Continuing Medical Education (ACCME) to provide continuing medical education for physicians.

CREDIT DESIGNATION

The University Of South Carolina School Of Medicine — Palmetto Health Continuing Medical Education Organization designated this live activity for a maximum of 19 *AMA PRA Category 1 Credits™*.

Physicians should claim only the credit commensurate with the extent of their participation in the activity.

This CME activity is planned and presented in accordance with all ACCME Essential Areas and Elements (including the Standards for Commercial Support) and Accreditation Policies.

If you would like Continuing Medical Education (CME) Credit for attending Workshops and Concurrent Sessions, please sign in and out at the door of that particular session.

If you would like Continuing Medical Education (CME) Credit for attending the poster session, please fill out the CME poster form and return the form to the conference staff personnel located by the poster exhibit.

DISCLOSURES AND RESOLUTION OF CONFLICT OF INTEREST

All faculty are required to disclose any relevant financial relationships. Relevant financial relationships and acknowledgements of commercial support will be disclosed to participants at the beginning of each educational session. Faculty are required to disclose off-label/investigative uses of commercial products/devices. Conflicts of interest are assessed and resolved through a review process conducted under the direction of The University of South Carolina School of Medicine — Palmetto Health Continuing Medical Education Organization.

BROUGHT TO YOU BY



www.susme.org



www.winfocus.org

HOSTED BY



UNIVERSITY OF
SOUTH CAROLINA
School of Medicine

www.med.sc.edu



TABLE OF CONTENTS

- World Congress Schedule, Friday, September 27 1
- A Taste of the South Event 6
- World Congress Schedule, Saturday, September 28 7
- BBQ at the Zoo Event 13
- World Congress Schedule, Sunday, September 29 14
- Poster Session Participants 17
- Faculty and Speaker Bio Sketches 19
- World Congress Planning Committee 31
- Partnerships and Supporters 32
- Convention Center Floor Plan 37
- Exhibit Hall Floor Plans 38
- Map of Downtown Columbia 39
- Free WiFi Connection 40
- Schedule At-A-Glance 41

| TIME | TITLE/TOPIC | PRESENTER | ROOM |
|--|--|---|---|
| 7:30 – 8:30 AM | Continental Breakfast | | Exhibit Hall and Lobby of Columbia Ballroom A |
| 7:30 AM – 5:30 PM | Registration Open | | Upper Level |
| 7:30 AM – 5:30 PM | Exhibit Hall Open | | Exhibit Hall |
| 8:00 – 8:30 AM | World Congress Welcome | Richard Hoppmann <i>Dean, University of South Carolina School of Medicine</i> Harris Pastides <i>President, University of South Carolina</i> | Columbia Ballroom A & B |
| PLENARY 1: 8:30 – 10:00 AM | | MODERATOR: MICHAEL BLAIVAS | |
| 8:30 – 9:00 AM | Advances in ultrasound technology: From the Waterbath to the Tricorder | Tomislav Petrovic | Columbia Ballroom A & B |
| 9:00 – 9:30 AM | The breadth of ultrasound applications | Beatrice Hoffmann | Columbia Ballroom A & B |
| 9:30 – 10:00 AM | Why we should think: Ultrasound First | Steven Goldstein | Columbia Ballroom A & B |
| 10:00 – 10:30 AM | BREAK | | Exhibit Hall |
| PLENARY 2: 10:30 AM – 12:00 PM | | MODERATOR: ENRICO STORTI | |
| 10:30 – 11:00 AM | Using ultrasound to teach the basic sciences | Kevin Evans | Columbia Ballroom A |
| 11:00 – 11:30 AM | The new simulation: Ultrasound | Vicki Noble | Columbia Ballroom A |
| 11:30 AM – 12:00 PM | Ultrasound pattern recognition to teach clinical medicine and improve patient care | Luca Neri | Columbia Ballroom A |
| 12:00 – 1:30 PM | LUNCH and POSTER SESSION 1 (See Page 17 and 18) | | Exhibit Hall |
| CONCURRENT SESSIONS, ABSTRACTS AND WORKSHOPS 1: 1:30 - 3:00 PM | | | |
| CONCURRENT 1: | HIGHLIGHTS AND PANEL DISCUSSION: SIX MEDICAL SCHOOLS ULTRASOUND CURRICULA | MODERATOR: JENNY MLADENOVIC | |
| 1:30 – 1:40 PM | An ultrasound student portfolio | Dave Bahner, <i>The Ohio State University</i> | Columbia C |
| 1:40 – 1:50 PM | Instructional iTunes | Chris Fox, <i>University of California, Irvine</i> | Columbia C |
| 1:50 – 2:00 PM | Ultrasound OSCEs | Vic Rao, <i>University of South Carolina</i> | Columbia C |
| 2:00 – 2:10 PM | Training M4s as effective educators | Teresa Liu, <i>George Washington University</i> | Columbia C |
| 2:10 – 2:20 PM | Blending the ultrasound program and the simulation center | Jongyeol Kim, <i>Texas Tech University</i> | Columbia C |
| 2:20 – 2:30 PM | Anatomy website | Craig Goodmurphy, <i>Eastern Virginia Medical School</i> | Columbia C |
| 2:30 – 3:00 PM | Panel discussion | | Columbia C |

| TIME | TITLE/TOPIC | PRESENTER | ROOM |
|---|--|---|--------------|
| CONCURRENT SESSIONS, ABSTRACTS AND WORKSHOPS 1: 1:30 - 3:00 PM | | | |
| CONCURRENT 2 | CRITICAL CARE ULTRASOUND | MODERATOR: SHAWN CHILLAG | |
| 1:30 – 1:45 PM | Vascular access | Jose Pazeli, Jr. | Hall of Fame |
| 1:45 – 2:00 PM | Airway management | Radovan Radonic | Hall of Fame |
| 2:00 – 2:15 PM | When is Trans-esophageal ECHO needed | Gabriele Via | Hall of Fame |
| 2:15 – 2:30 PM | Volume assessment and management | Alex Levitov | Hall of Fame |
| 2:30 – 2:45 PM | The Blue protocol | Daniel Lichtenstein | Hall of Fame |
| 2:45 – 3:00 PM | Panel discussion | | Hall of Fame |
| ABSTRACT SESSION 1 | MEDICAL EDUCATION (GENERAL) 1:30 - 3:00 PM | MODERATOR: ERIKA BLANCK | |
| 1:30 – 1:45 PM | Impact of a single exposure to hands-on ultrasound education on student perceptions of ultrasound in medical education | Jennifer Cotton <i>University of Kentucky</i> | Congaree A |
| 1:45 – 2:00 PM | Undergraduate bedside ultrasound teaching at McGill University medical school | Peter Steinmetz <i>McGill University</i> | Congaree A |
| 2:00 – 2:15 PM | Bedside ultrasonography in clinical education and practice survey: Evaluation of a pilot educational intervention for medical students | Katarzyna A. Hampton <i>Geisinger Health Systems</i> | Congaree A |
| 2:15 – 2:30 PM | Using ultrasound to teach physical examination skills – medical educators' perspectives | Irene Ma <i>University of Calgary</i> | Congaree A |
| 2:30 – 2:45 PM | Does the addition of an integrated cardiac ultrasound curriculum to the first-year of undergraduate medical education enhance comprehension of cardiac physiology? | Frank Lattanzio <i>Eastern Virginia Medical School</i> | Congaree A |
| 2:45 – 3:00 PM | State of ultrasound in undergraduate medical education: A national survey of medical school curricula | Nelson Royall <i>Orlando Health, The Ohio State University, George Washington University</i> | Congaree A |

| TIME | TITLE/TOPIC | PRESENTER | ROOM |
|---|--|---|---------------------|
| ABSTRACT SESSION 2 | CLINICAL MEDICINE 1:30 - 3:00 PM | MODERATOR: RUTH RILEY | |
| 1:30 PM | Estimation of spleen size with hand carried ultrasound | J. Mark Roberts <i>University of British Columbia</i> | Congaree B |
| 1:45 PM | General internist performed point-of-care ultrasound assessment of left ventricular function correlates with formal echocardiography | David Tierney <i>Abbott Northwestern Hospital</i> | Congaree B |
| 2:00 PM | Using ultrasound to identify radial artery position prior to arterial blood gasses | Rebecca Corbett <i>Western University of Health Sciences</i> | Congaree B |
| 2:15 PM | Augmenting physical examination skills with point-of-care ultrasound: Utilizing simulation technology to teach visualization of the abdominal aorta and kidneys to internal medicine residents | Diana Kelm <i>Mayo Clinic Rochester</i> | Congaree B |
| 2:30 PM | Hocus pocus or important tool? A point of care ultrasound (POCUS) curriculum in surgical ICU fellowship training changes patient care | Dana Hommel <i>Henry Ford Health System</i> | Congaree B |
| 2:45 PM | Central vascular catheter placement evaluation using saline flush and bedside echocardiography | Anthony J. Weekes <i>Carolinas Medical Center</i> | Congaree B |
| ULTRASOUND WORKSHOPS: 1:30 - 3:00 PM | | INSTRUCTORS | |
| WORKSHOP 1 | Introduction to Ultrasound - Students <i>Co-Leaders: Tripp Bell, Duncan Howe</i> | Jeff Hall Vaughan Lee Jim Connolly | Lexington A |
| WORKSHOP 2 | Introduction to Ultrasound <i>Co-Leaders: Mary Beth Poston, Matt Garber</i> | Harvey Nisenbaum Francis Neuffer Faye Kuperman | Lexington B |
| WORKSHOP 3 | Vascular Ultrasound - Aorta and Inferior Vena Cava <i>Co-Leaders: John Pellerito, Philippe Pes</i> | Joseph Minardi Maxime Valois Eugene Zierler | Richland A |
| WORKSHOP 4 | Trauma – eFAST Exam <i>Co-Leaders: Stephen Smith, Adi Osman</i> | Barry Knapp Daniel Pedrollo Mike Mallin Keith Killu | Richland B |
| WORKSHOP 5 | Basic OB-GYN Ultrasound <i>Co-Leaders: Alfred Abuhamad, Judy Burgis</i> | Kerry Sims Beryl Benacerraf Oscar Barahona Diana Dowdy | Richland C |
| 3:00 – 3:30 PM | BREAK | | Exhibit Hall |

| TIME | TITLE/TOPIC | PRESENTER | ROOM |
|---|--|---|------------|
| CONCURRENT SESSIONS, ABSTRACTS AND WORKSHOPS 2: 3:30 - 5:00 PM | | | |
| CONCURRENT 3: | ULTRASOUND EDUCATION MATERIALS | MODERATOR: MEERA NARASIMHAN | |
| 3:30 – 3:45PM | E-books and apps | Gregor Prosen | Columbia C |
| 3:45 – 4:00 PM | Online learning | Jim Connolly | Columbia C |
| 4:00 – 4:15 PM | Websites of organizations and manufacturers | Mike Blaivas | Columbia C |
| 4:15 – 4:30 PM | Important journals and article services | Larry Melniker | Columbia C |
| 4:30 – 4:45 PM | Blended educational materials | Raoul Breitreutz | Columbia C |
| 4:45 – 5:00 PM | Panel discussion | | Columbia C |
| ABSTRACT SESSION 3 | MEDICAL EDUCATION METHODOLOGY 3:30 - 5:00 PM | MODERATOR: ANDY SIDES | |
| 3:30 – 3:45PM | PowerPoint presentations in ultrasound teaching - still appropriate? | Doretha Hempel <i>Medizinische Klinik und Poliklinik, Universitätsmedizin Mainz</i> | Congaree A |
| 3:45 – 4:00 PM | Incorporating an external assessment program into the educational continuum: The ARDMS pilot tests for WINFOCUS cardiac ultrasound | Eugene Zierler <i>American Registry for Diagnostic Medical Sonography (ARDMS)</i> | Congaree A |
| 4:00 – 4:15 PM | Assessment of a new e-learning system on thorax, trachea and lung ultrasound | Doretha Hempel <i>Medizinische Klinik und Poliklinik, Universitätsmedizin Mainz</i> | Congaree A |
| 4:15 – 4:30 PM | Pre-medical student perceptions of an ultrasound medical curriculum | Courtney Poston <i>Clemson University/ University of South Carolina School of Medicine</i> | Congaree A |
| 4:30 – 4:45 PM | ICU ultrasound rounds: A novel method of exposing students to ultrasound pathology | Rebekah Zaiser <i>The Ohio State University</i> | Congaree A |
| 4:45 – 5:00 PM | Multidisciplinary Educational initiative Training of Regional Ultrasound Specialists (MENTORS) program | Zachary Phillip Soucy <i>University of California, Davis</i> | Congaree A |
| ABSTRACT SESSION 4 | GLOBAL EXPERIENCE 3:30 - 5:00 PM | MODERATOR: NANCY RICHESON | |
| 3:30 – 3:45PM | Feasibility of ultrasound integration into medical education in a limited resource setting in Lebanon | Reem Abu-Rustum <i>Center for Advanced Fetal Care (Lebanon)</i> | Congaree B |
| 3:45 – 4:00 PM | First year medical students' perceptions of the importance of ultrasound in medical education in Lebanon | Reem Abu-Rustum <i>Center for Advanced Fetal Care (Lebanon)</i> | Congaree B |

| TIME | TITLE/TOPIC | PRESENTER | ROOM |
|---|---|---|----------------|
| ABSTRACT SESSION 4 | GLOBAL EXPERIENCE 3:30 - 5:00 PM | MODERATOR: NANCY RICHESON | |
| 4:00 – 4:15 PM | Development of a bedside echocardiogram training program in Mbeya, Tanzania | Jeff Hall <i>University of South Carolina</i> | Congaree B |
| 4:15 – 4:30 PM | Ultrasound as a diagnostic tool for malaria in Mwanza, Tanzania | Michelle Zhou <i>University of California, Irvine School of Medicine</i> | Congaree B |
| 4:30 – 4:45 PM | Accuracy of point-of-care cardiac ultrasound in Chagas disease by a non-cardiologist with limited training | Lucas Kreuser <i>University of Minnesota</i> | Congaree B |
| 4:45 – 5:00 PM | Introduction to ultrasound curriculum established for students at Tandabui Institute of Health Sciences and Technology (Mwanza, Tanzania) | John Fox <i>University of California, Irvine</i> | Congaree B |
| ULTRASOUND WORKSHOPS: 3:30 - 5:00 PM | | INSTRUCTORS | |
| WORKSHOP 6 | Vascular Access <i>Co-Leaders: Bret Nelson, Radovan Radonic</i> | Tomas Villen Paula Nocera Dave Spear | Lexington A |
| WORKSHOP 7 | Ultrasound of the Abdomen (Liver, Kidney, Spleen and Pancreas) <i>Leader: Anjali Bhagra</i> | Jose Pazelli Maguel Montorfano Abdulmunhem Obaideen | Lexington B |
| WORKSHOP 8 | Lung Ultrasound <i>Co-Leaders: Daniel Lichtenstein, Anthony Dean</i> | Vicki Noble Ramon Nogue Deepak Govil | Richland A |
| WORKSHOP 9 | Musculoskeletal Ultrasound <i>Co-Leaders: Gurjit Kaely, Randy Westerkam</i> | Kevin Evans Jean-Francois Lancot Chris Fox Bee Tan-Sales | Richland B |
| WORKSHOP 10 | Ultrasound to Teach Physiology <i>Co-Leaders: Britt Wilson, Vic Rao</i> | Maxime Valois Bob Jarman Jongyeal Kim | Richland C |
| WORKSHOP 11 | Introduction to Ultrasound <i>Leader: Tripp Bell</i> | Duncan Howe Catherine Erickson Faye Kuperman Zubair Chao | Carolina A & B |
| SPECIAL EVENING EVENT | | | |
| 7:00 - 9:00 PM | WELCOME RECEPTION COLUMBIA MUSEUM OF ART 1515 MAIN STREET . COLUMBIA, SOUTH CAROLINA | | |

SECOND WORLD CONGRESS
ULTRASOUND IN MEDICAL EDUCATION
SEPTEMBER 27 - 29, 2013

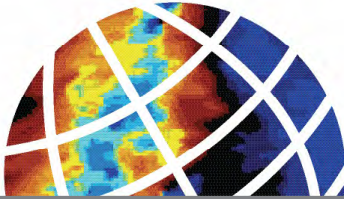

A Taste of the South
WELCOME RECEPTION

University of South Carolina School of Medicine

cordially invites you to attend

“A Taste of the South”

welcome reception for the

Second World Congress on

Ultrasound in Medical Education

Friday, September 27, 2013

7:00 - 9:00 P.M.

Columbia Museum of Art

1515 Main Street

Columbia, South Carolina 29201

SPONSORED BY:  **SonoSite**
FUJIFILM

*For your convenience, a shuttle will run continuously from the
Columbia Metropolitan Convention Center to the Columbia Museum
of Art from 6:45 to 9:15 p.m.*

| TIME | TITLE/TOPIC | PRESENTER | ROOM |
|---|---|--|--|
| 7:15 – 8:30 AM | Continental Breakfast | | Lobby of Columbia Ballroom A and Exhibit Hall |
| 7:15 – 8:15 AM | Interest Group 1 Breakfasts Student Interest Group Basic Science Interest Group | | Exhibit Hall Exhibit Hall |
| 7:15 – 8:15 AM | SUSME Board Meeting | | Spires Board Room |
| 7:15 AM – 3:30 PM | Exhibit Hall Open | | Exhibit Hall |
| 7:30 AM – 5:00 PM | Registration Open | | Upper Level |
| 8:15 – 8:30 AM | Meeting Update | Richard Hoppmann <i>Dean, University of South Carolina School of Medicine</i> | Columbia Ballroom A |
| PLENARY 3: 8:30 – 10:00 AM | | MODERATOR: JENNY MLADENOVIC | |
| 8:30 – 9:00 AM | Remote Ultrasound: From the point of trauma to the Space Station | Bret Nelson | Columbia Ballroom A & B |
| 9:00 – 9:30 AM | They said it couldn't be done: lung ultrasound | Giovanni Volpicelli | Columbia Ballroom A & B |
| 9:30 – 10:00 AM | Ultrasound as a core clinical skill in a competency-based curriculum | Richard Hoppmann | Columbia Ballroom A & B |
| 10:00 – 10:30 AM | BREAK | | Exhibit Hall |
| PLENARY 4: 10:30 AM – 12:00 PM | | MODERATOR: TOMISLAV PETROVIC | |
| 10:30 – 11:00 AM | Reaching consensus on ultrasound standards | Mahmoud Elbarbary | Columbia Ballroom A & B |
| 11:00 – 11:30 AM | Improving maternal-fetal survival through ultrasound education – locally and globally | Alfred Abuhamad | Columbia Ballroom A & B |
| 11:30 AM – 12:00 PM | Teaching and advancing ultrasound through videos and podcasting | Mike Mallin Matt Dawson | Columbia Ballroom A & B |
| 12:00 – 1:30 PM | LUNCH AND POSTER SESSION 2 (SEE PAGE 18) | | Exhibit Hall |
| CONCURRENT SESSIONS, ABSTRACTS AND WORKSHOPS 3: 1:30 - 3:00 PM | | | |
| CONCURRENT 4: | INITIATING AN ULTRASOUND CURRICULUM FROM A TO Z | MODERATOR: DAVE BAHNER | |
| 1:30 – 1:40 PM | Acquiring ultrasound systems | Abdulmunhem Obaideen | Columbia C |
| 1:40 – 1:50 PM | Finding time in the curriculum for ultrasound | Grace Gonzaga | Columbia C |
| 1:50 – 2:00 PM | Recruiting faculty to teach ultrasound | John Pellerito | Columbia C |
| 2:00 – 2:10 PM | Ultrasound educational materials | Joseph Minardi | Columbia C |
| 2:10 – 2:20 PM | Establishing partnerships across departments | Gregory Hays | Columbia C |
| 2:20 – 2:30 PM | Convincing administrators of the value of an ultrasound curriculum | Richard Hoppmann | Columbia C |
| 2:30 – 3:00 PM | Panel discussion | | Columbia C |

| TIME | TITLE/TOPIC | PRESENTER | ROOM |
|---|--|---|--------------|
| CONCURRENT SESSIONS, ABSTRACTS AND WORKSHOPS 3: 1:30 - 3:00 PM | | | |
| CONCURRENT 5: | STATE OF ULTRASOUND TRAINING ACROSS DISCIPLINES | MODERATOR: MARY BETH POSTON | |
| 1:30 – 1:45 PM | Sonographers | Eugene Zierler | Hall of Fame |
| 1:45 – 2:00 PM | Nurse midwives | Diana Dowdy | Hall of Fame |
| 2:00 – 2:15 PM | Medical residents | Anjali Bhagra | Hall of Fame |
| 2:15 – 2:30 PM | Veterinarians | Joyce Holt Linda Luther | Hall of Fame |
| 2:30 – 2:45 PM | Medics and emergency medical technicians | James Palma | Hall of Fame |
| 2:45 – 3:00 PM | Panel discussion | | Hall of Fame |
| ABSTRACT SESSION 5 | MEDICAL EDUCATION METHODOLOGY 1:30 - 3:00 PM | MODERATOR: JAMES CATROPPO | |
| 1:30 – 1:45 PM | Enhancing the toolbox of medical students with basic ultrasound skills using the “FLIPPED CLASS-ROOM” approach | Galit Dichterman <i>Carmel Medical Center</i> | Congaree A |
| 1:45 – 2:00 PM | Integrating donor dissection, simulation and live ultrasound, of the femoral region during an anatomy lab course enables first year medical students to conduct femoral nerve blocks | Adam Mina <i>Western University of Health Sciences</i> | Congaree A |
| 2:00 – 2:15 PM | Advanced competencies internal medicine focused ultrasound at the UME level | Saaïd Abdel-Ghani <i>The Ohio State University</i> | Congaree A |
| 2:15 – 2:30 PM | Development of a novel clinical ultrasound thread in a third year longitudinal integrated medical school curriculum at a satellite campus | Margaret Lewis <i>Carolinas Medical Center</i> | Congaree A |
| 2:30 – 2:45 PM | Development of an advanced competency curriculum in focused ultrasonography for medical students to assist in transition to graduate medical education | Ashish R. Panchal <i>The Ohio State University</i> | Congaree A |
| 2:45 – 3:00 PM | Learner improvement and appreciation from a blended-learning, simulation-enhanced ultrasonography curriculum for first-year medical students | Geoffrey Miller <i>Eastern Virginia Medical School / Old Dominion University</i> | Congaree A |
| ABSTRACT SESSION 6 | DEVICES, PHANTOMS AND TECHNOLOGY 1:30 - 3:00 PM | MODERATOR: J.T. THORNHILL | |
| 1:30 – 1:45 PM | Affordable, PC-based ultrasound training simulator | Peder Pedersen <i>Worcester Polytechnic Institute</i> | Congaree B |
| 1:45 – 2:00 PM | Using balloons, bullets and superheroes to construct a graded set of US gel trainers for artifact and knobology training | Craig Goodmurphy <i>Eastern Virginia Medical School</i> | Congaree B |

| TIME | TITLE/TOPIC | PRESENTER | ROOM |
|---|--|--|---------------------|
| ABSTRACT SESSION 6 | DEVICES, PHANTOMS AND TECHNOLOGY 1:30 - 3:00 PM | MODERATOR: J.T. THORNHILL | |
| 2:00 – 2:15 PM | Demonstrating the feasibility of remote hands on ultrasound skills education using high speed multipoint internet connections - the UCI – UNE Connection | Peter Philip McKeown <i>University of New England School of Rural Medicine, Armidale, Australia</i> | Congaree B |
| 2:15 – 2:30 PM | Kitchen or crime lab: Cooking up Knox® and Ballistic Gelatin in the development of ultrasound trainers for medical education | Shariff Tanious <i>Eastern Virginia Medical School</i> | Congaree B |
| 2:30 – 2:45 PM | Teaching an ultrasound guided invasive procedure to first year medical students using a novel finger transducer | Rebecca Corbett <i>Western University of Health Sciences</i> | Congaree B |
| 2:45 – 3:00 PM | Can anatomists teach living anatomy using ultrasound as a teaching tool? | Teresa Liu <i>The George Washington University, School of Medicine and Health Sciences</i> | Congaree B |
| ULTRASOUND WORKSHOPS: 1:30 - 3:00 PM | | INSTRUCTORS | |
| WORKSHOP 1 | Single Probe Comprehensive Examination <i>Co-Leaders: Daniel Lichtenstein, Ramon Nogue</i> | Anthony Dean Jim Connolly Rob Ferre | Lexington A |
| WORKSHOP 2 | Basic OB-GYN Ultrasound <i>Co-Leaders: Alfred Abuhamad, Judy Burgis</i> | Allison Jackson Beatrice Hoffmann Oscar Barahona | Richland C |
| WORKSHOP 3 | Pediatric Ultrasound <i>Co-Leaders: Jim Tsung, Mahmoud Elbarbary</i> | Ee Tay Bret Nelson Margaret Lewis Osborne Schuler Matt Garber | Richland A |
| WORKSHOP 4 | Transcranial Doppler and Carotid Ultrasound <i>Co-Leaders: Souvik Sen, Jongyeol Kim</i> | Paisyith Piriawat Philippe Pes John Bennett | Richland B |
| WORKSHOP 5 | Ultrasound to Teach Anatomy <i>Co-Leaders: Jim Wells, Tripp Bell</i> | Craig Goodmurphy Noel Boaz Rick Sikon Erika Blanck | Lexington B |
| 3:00 – 3:30 PM | BREAK | | Exhibit Hall |

| TIME | TITLE/TOPIC | PRESENTER | ROOM |
|---|--|---|--------------|
| CONCURRENT SESSIONS, ABSTRACTS AND WORKSHOPS 4: 3:30 - 5:00 PM | | | |
| CONCURRENT 6: | ENHANCING WOMEN'S HEALTH WITH ULTRASOUND--LOCALLY AND GLOBALLY | MODERATOR: ANJALI BHAGRA | |
| 3:30 – 3:45 PM | Safety issues: Repeat ultrasound exams, limiting the risk | Oscar Barahona | Columbia C |
| 3:45 – 4:00 PM | Screening for disease: The role of ultrasound in screening for ovarian cancer | Steven Goldstein | Columbia C |
| 4:00 – 4:15 PM | Pelvic pain | Beryl Benacerraf | Columbia C |
| 4:15 – 4:30 PM | Tele-OB care | Luca Neri | Columbia C |
| 4:30 – 5:00 PM | Panel discussion | | Columbia C |
| CONCURRENT 7: | TEACHING ANATOMY, PHYSIOLOGY AND PATHOLOGY WITH ULTRASOUND | MODERATOR: RICH GOODWIN | |
| 3:30 – 3:45 PM | Ultrasound in teaching anatomy | Vaughan Lee | Hall of Fame |
| 3:45 – 4:00 PM | The Thiel Cadaver | Noel Boaz | Hall of Fame |
| 4:00 – 4:15 PM | Ultrasound to enhance medical pathology | James Catroppo | Hall of Fame |
| 4:15 – 4:30 PM | Ultrasound in teaching physiology | Britt Wilson | Hall of Fame |
| 4:30 – 5:00 PM | Panel discussion | | Hall of Fame |
| ABSTRACT SESSION 7 | CLINICAL MEDICINE 3:30 - 5:00 PM | MODERATOR: DEB KROTISH | |
| 3:30 – 3:45 PM | A prospective analysis of single operator sonographic optic nerve sheath diameter measurement for diagnosis of elevated intracranial pressure | Joelle Schlang <i>University of California, Irvine School of Medicine</i> | Congaree A |
| 3:45 – 4:00 PM | Ultrasound - novel monitoring of CPR | Andy Berglund <i>Western University of Health Sciences</i> | Congaree A |
| 4:00 – 4:15 PM | Enhancing ultrasound education through volunteer participation in cardiac screening | Mason Shieh <i>University of California, Irvine</i> | Congaree A |
| 4:15 – 4:30 PM | The effects of positional change on IVC diameter in the euvoletic and volume depleted subject | Max Mam <i>Medical College of Georgia, Georgia Regents University</i> | Congaree A |
| 4:30 – 4:45 PM | Hospitalists' ability to use hand-carried ultrasound for central venous pressure estimation after a brief training intervention: A pilot study | L. David Martin <i>Johns Hopkins University School of Medicine, Johns Hopkins Bayview Medical Center</i> | Congaree A |

| TIME | TITLE/TOPIC | PRESENTER | ROOM |
|---|--|--|-------------|
| ABSTRACT SESSION 7 | CLINICAL MEDICINE, CONTINUED 3:30 - 5:00 PM | MODERATOR: DEB KROTISH | |
| 4:45 – 5:00 PM | Successful Introduction of an advanced course in ultrasound for senior medical students on a rural placement | Peter Philip McKeown <i>University of New England School of Rural Medicine, Armidale, Australia</i> | Congaree A |
| ABSTRACT SESSION 8 | GENERAL MEDICAL EDUCATION + GLOBAL EXPERIENCE 3:30 - 5:00 PM | MODERATOR: SHAWN CHILLAG | |
| 3:30 – 3:45 PM | Implementation of a focused ultrasound guided vascular access program for medical students | Alexandra Dyer <i>The Ohio State University Wexner Medical Center</i> | Congaree B |
| 3:45 – 4:00 PM | Spatial abilities and ultrasonography: Do differences between male and female medical students matter? | Mark W. Scerbo <i>Eastern Virginia Medical School / Old Dominion University</i> | Congaree B |
| 4:00 – 4:15 PM | Implementation of bedside ultrasonography within an internal medicine faculty and residency using a “Nidus” instructor strategy: The IMBUS program | David Tierney <i>Abbott Northwestern Hospital</i> | Congaree B |
| 4:15 – 4:30 PM | Effectiveness of an institutional faculty development course and barriers to training/education of faculty for integration of ultrasound in medical education | Jongyeol Kim <i>Texas Tech University Health Sciences Center School of Medicine</i> | Congaree B |
| 4:30 – 4:45 PM | Attitudes and potential barriers to integration of longitudinal ultrasound to medical education curriculum: A survey of medical school faculty | Jongyeol Kim <i>Texas Tech University Health Sciences Center School of Medicine</i> | Congaree B |
| 4:45 – 5:00 PM | Evaluating didactic methods for training medical students at The Faculty of Medicine in Transylvania, Romania in the use of bedside ultrasound for clinical practice | Cosmin Florescu <i>University of California, Irvine School of Medicine</i> | Congaree B |
| ULTRASOUND WORKSHOPS: 3:30 - 5:00 PM | | INSTRUCTORS | |
| WORKSHOP 6 | Ultrasound Guided Procedures <i>Co-Leaders: Joseph Minardi, Suthaporn Lumlertgul</i> | Deepak Govil Dave Spear Mike Blaivas | Lexington A |
| WORKSHOP 7 | Introduction to ECHO <i>Co-Leaders: Gabriele Via, Osborne Shuler</i> | Young-Rock Ha Maxime Valois Rajesh Vakani Arif Hussain | Lexington B |

| TIME | TITLE/TOPIC | INSTRUCTORS | ROOM |
|---|---|--|----------------|
| ULTRASOUND WORKSHOPS: 3:30 - 5:00 PM | | | |
| WORKSHOP 8 | Hand-Held Ultrasound Devices <i>Co-Leaders: Bob Jarman, Barry Knapp</i> | Philippe Pes Vic Rao Bernard Bulwer | Richland A |
| WORKSHOP 9 | Deep Venous Thrombosis <i>Co-Leaders: Daniel Pedrollo, Tomislav Petrovic</i> | Raoul Breitzkreutz Chris Fox Kevin Evans | Richland B |
| WORKSHOP 10 | Multi-System Approach to Shock <i>Co-Leaders: Vicki Noble, Alex Levitov</i> | Keith Killu Giovanni Volpicelli Teresa Liu | Richland C |
| SPECIAL MEETINGS AND EVENING EVENT | | | |
| 4:30 – 6:30 PM | WINFOCUS BOARD MEETING | | Carolina A & B |
| 7:00 – 9:00 PM | BBQ AT THE ZOO RIVERBANKS ZOO AND GARDEN | | |

SECOND WORLD CONGRESS

ULTRASOUND IN MEDICAL EDUCATION

SEPTEMBER 27 - 29, 2013

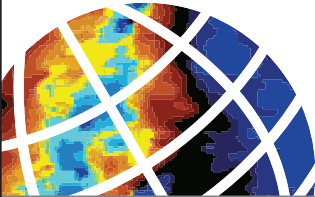

BBQ AT THE ZOO

University of South Carolina School of Medicine

cordially invites you to attend

“BBQ at the Zoo”

special event for the

Second World Congress on

Ultrasound in Medical Education

Saturday, September 28, 2013

7:00 - 9:00 P.M.

Riverbanks Zoo and Garden

500 Wildlife Parkway

Columbia, South Carolina 29210

*For your convenience, a shuttle will run continuously from the
Columbia Metropolitan Convention Center to the Riverbanks Zoo and
Garden from 6:45 to 9:15 p.m.*

| TIME | TITLE/TOPIC | PRESENTER | ROOM |
|--|---|--|------------------------------|
| 7:30 – 8:00 AM | Coffee | | Lobby of Columbia Ballroom A |
| 7:30 – 11:30 AM | Registration Open | | Upper Level |
| 8:00 – 8:15 AM | Meeting Update | Richard Hoppmann <i>Dean, University of South Carolina School of Medicine</i> | Columbia Ballroom A & B |
| PLENARY 5: 8:15 – 9:30 AM | | MODERATOR: RICHARD HOPPMANN | |
| 8:15 – 8:45 AM | Ultrasound education: A global perspective | Michael Blaivas | Columbia Ballroom A & B |
| 8:45 – 9:15 AM | Faculty development in ultrasound education: Closing the gap | Jenny Mladenovic | Columbia Ballroom A & B |
| 9:15 – 9:30 AM | Awards presentations -SUSME Legacy Awards -Image competition -Poster competition | Richard Hoppmann | Columbia Ballroom A & B |
| 9:30 – 9:45 AM | BREAK | | |
| CONCURRENT SESSIONS, ABSTRACTS AND WORKSHOPS 5: 9:45 - 11:15 AM | | | |
| CONCURRENT 8: | STATE OF ULTRASOUND EDUCATION AROUND THE GLOBE | MODERATOR: ENRICO STORTI | |
| 9:45 – 9:55 AM | Brazil | Marcus Bastos | Columbia C |
| 9:55 – 10:05 AM | South Korea | Young-Rock Ha | Columbia C |
| 10:05 – 10:15 AM | Argentina | Miguel Montorfano | Columbia C |
| 10:15 – 10:25 AM | United Kingdom | Bob Jarman | Columbia C |
| 10:25 – 10:35 AM | Gulf Region | Mahmoud Elbarbary | Columbia C |
| 10:35 – 10:45 AM | Italy | Enrico Storti | Columbia C |
| 10:45 – 11:15 AM | Discussion | | Columbia C |

| TIME | TITLE/TOPIC | PRESENTER | ROOM |
|--------------------------------|--|--|------------|
| ABSTRACT SESSION 9 | MEDICAL EDUCATION METHODOLOGY 9:45 - 11:15 AM | MODERATOR: RUTH RILEY | |
| 9:45 – 10:00 AM | Integration of ultrasound in academic medicine: Organizational trends, themes, threads and transformation in a Philippine medical school | Jocelyn Myra <i>University of Santo Tomas Faculty of Medicine & Surgery</i> | Congaree A |
| 10:00 – 10:15 AM | Effectiveness of an evidence-based critical care ultrasound course | Susan Pasnick <i>University of California San Francisco</i> | Congaree A |
| 10:15 – 10:30 AM | Trained Simulated Ultrasound Patients (TSUP): Models, learners and proctors | Creagh Boulger <i>The Ohio State University Wexner Medical Center</i> | Congaree A |
| 10:30 – 10:45 AM | Examining the surface and scanning within: Point-of-care ultrasound curriculum for first-year medical students | Bret Nelson <i>Icahn School of Medicine at Mount Sinai</i> | Congaree A |
| 10:45 – 11:00 AM | Assessment of a low cost pericardiocentesis model | Dorothea Hempel <i>Medizinische Klinik und Poliklinik, Universitätsmedizin Mainz</i> | Congaree A |
| ABSTRACT SESSION 10 | CLINICAL MEDICINE, PHANTOMS, TECHNOLOGY, ETC. 9:45 - 11:15 AM | MODERATOR: DON KENNEY | |
| 9:45 – 10:00 AM | A novel cross-departmental pelvic ultrasound training course utilizing a hybrid of live and simulation models improves resident competency | Amy Sanghvi <i>Icahn School of Medicine at Mount Sinai</i> | Congaree B |
| 10:00 – 10:15 AM | Impact of an EM ultrasound-guided nerve block training course in Porto Alegre, Hospital Pronto Socorro – case series | Daniel Fontana Pedrollo <i>Emergency Department Hospital de Clinicas de Porto Alegre, Emergency Residency Program Hospital de Pronto Socorro Porto Alegre</i> | Congaree B |
| 10:15 – 10:30 AM | Confirmation of endotracheal tube placement utilizing ultrasound | Brion Benninger <i>Western University of Health Sciences</i> | Congaree B |
| 10:30 – 10:45 AM | Ultrasound guided vascular access on a phantom: A training model for medical student education | Lydia Sahlani <i>The Ohio State University Wexner Medical Center</i> | Congaree B |
| 10:45 – 11:00 AM | Echo-Guided Life Support (EGLS): An algorithmic approach to the patient in shock | Maxime Valois <i>Montreal University</i> | Congaree B |

| TIME | TITLE/TOPIC | INSTRUCTORS | ROOM |
|---|--|---|-------------|
| ULTRASOUND WORKSHOPS: 9:45 - 11:15 AM | | | |
| WORKSHOP 1 | Introduction to Ultrasound <i>Co-Leaders: Tripp Bell, Duncan Howe</i> | Faye Kuperman Francis Neuffer | Lexington A |
| WORKSHOP 2 | Lung Ultrasound <i>Co-Leaders: Giovanni Volpicelli, Michael Blaivas</i> | Jim Tsung Margaret Lewis | Lexington B |
| WORKSHOP 3 | Hand-Held Ultrasound Devices <i>Co-Leaders: Bernard Bulwer, Jim Connolly</i> | Osborne Shuler Beatrice Hoffmann | Richland A |
| WORKSHOP 4 | Multi-System Approach to Shock <i>Co-Leaders: Ramon Nogue, Enrico Storti</i> | Carmela Graci Jean-Francois Lanctot | Richland B |
| WORKSHOP 5 | Vascular Ultrasound – Aorta and Inferior Vena Cava <i>Co-Leaders: Chris Fox, Tomas Villen</i> | Rob Ferre Eugene Zierler Jeff Hall | Richland C |
| 11:15 – 11:30 AM | BREAK | | |
| ULTRASOUND WORKSHOPS: 11:30 AM - 1:00 PM | | | |
| WORKSHOP 6 | Nerve Blocks <i>Co-Leaders: Paula Nocera, Raoul Breitzkreutz</i> | Dave Spear Michael Blaivas Vic Rao | Lexington A |
| WORKSHOP 7 | Ultrasound of the Abdomen (Liver, Kidney, Spleen and Pancreas) <i>Leader: Dave Bahner</i> | Tripp Bell Faye Kuperman | Lexington B |
| WORKSHOP 8 | Ultrasound Guided Central Venous Access <i>Co-Leaders: Mahmoud Elbarbary, Arif Hussain</i> | Radovan Radonic Stephen Smith | Richland A |
| WORKSHOP 9 | Trauma – eFAST Exam <i>Co-Leaders: William Fry, Young-Rock Ha</i> | Anthony Dean Joseph Minardi Jose Pazeli | Richland B |

POSTER SESSION PARTICIPANTS

| AUTHOR | POSTER TITLE | BOARD NUMBER | SESSION |
|------------------------|---|--------------|---------|
| Natasha Gupta | Early detection of a molar pregnancy with sonography: A retrospective analysis and review of the literature | 1 | 1 |
| Solis Mirta | Prenatal diagnosis by ultrasound in two different cases of intra-toracic abnormalities | 2 | 1 |
| Justin Stone | Feasibility of sonographic localization of the inferior epigastric artery prior to ultrasound-guided paracentesis: a case series | 3 | 1 |
| Kevin Evans | Sonography of the glenoid labrum: Preclinical methodology for teaching and diagnostics | 4 | 1 |
| Jean-François Lanctôt | Sonographic physiology « 101 »: On shock states and fluid responsiveness | 5 | 1 |
| Kiah Bertoglio | A one-day symposium for bedside ultrasound training for medical students improves psychomotor performance | 6 | 1 |
| Kiah Bertoglio | Emergency department vs. radiology department pelvic ultrasound and effect on patient length of stay: A randomized control trial | 7 | 1 |
| Tatyana Kondrashova | Use of simulation training phantoms and real-time ultrasonography during the first and second years of medical school | 8 | 1 |
| Peter Kondrashov | Impact of the clinical ultrasound elective course on retention of anatomical knowledge by second-year osteopathic medical students in preparation for board exams | 9 | 1 |
| Joelle Schlang | Proactive medicine: An ultrasound-based clinical initiative: “The UC Irvine 30” | 10 | 1 |
| Bernard Bulwer | Echocardiography prevalence study using a new criteria for rheumatic heart disease in school children in Rwanda | 11 | 1 |
| Young-Rock Ha | The comparisons of clinical and sonographic characteristics between the early and late appendicitis | 12 | 1 |
| Robinson Ferre | Ultrasound guided central vascular access with a novel ultrasound device: Results from the first 100 lines | 13 | 1 |
| Brooke Hollins-McAdams | Utility of point-of-care thyroid Doppler ultrasonography in the evaluation of thyrotoxicosis and Graves’ disease | 14 | 1 |
| Ramon Nogué Bou | Descriptive analysis about the practice use of ultrasound in fourth-year medical students at University of Lleida (UdL) | 15 | 1 |
| Peter Philip McKeown | Evolutionary development of an Introduction to Ultrasound Course in a rural medical school | 16 | 1 |
| Ali Aldhebaib | Duplex ultrasound objective structured assessment of technical skills for arterial stenosis detection | 17 | 1 |
| Joseph Micumbitsi | Echocardiography prevalence study using a new criteria for rheumatic heart disease in school children in Rwanda | 18 | 1 |
| Adam Niku | Teaching ultrasound by exploring anatomy | 19 | 1 |
| Ashish R. Panchal | Integrated system of community practice for focused ultrasonography spanning UME, GME and faculty levels standardizing training, competency and quality. | 20 | 1 |
| Stephen Gee | The Ultrasound Interest Group (USIG): Incorporating ultrasound education and mentorship into the medical student experience | 21 | 1 |
| Catherine Nix | Challenges encountered while creating a “How we teach Inferior Vena Cava (IVC) Ultrasound” teaching video | 22 | 1 |
| Sodra Khan | Pelvic ultrasound in medical education: A community of practice | 23 | 1 |
| Saaïd Abdel-Ghani | Integration of ultrasound within the Department of Internal Medicine through a local community of practice initiative | 24 | 1 |
| Peregrina Gonzaga | Integration of ultrasound in the gross anatomy curriculum: Students’ reflection on experiential learning in a Philippine medical school | 25 | 1 |

POSTER SESSION PARTICIPANTS

| AUTHOR | POSTER TITLE | BOARD NUMBER | SESSION |
|-------------------------|---|--------------|---------|
| Nicholas Hoppmann | Hand-held ultrasonography to assess external chest compressions on a fresh cadaver | 26 | 1 |
| Nelson Royall | Improvement nomenclature for focused ultrasound in the emergency department for improved documentation practices | 27 | 1 |
| Margaret Lewis | Emergency ultrasound preceptorship as a model for continuing medical education | 28 | 1 |
| Lydia Sahlani | Using Twitter to deliver a question and answer curriculum in medical education | 29 | 2 |
| Lauren Sims | The Rural Obstetrical Ultrasound Triage Exam (ROUTE): Teaching obstetrical ultrasound to medical students interested in international applications | 30 | 2 |
| Laura J. Edwards | Challenges in facilitating an ultrasound training program in a cross-cultural, resource-limited setting: anecdotal reflections from Nakuru, Kenya | 31 | 2 |
| Julia Ojcius | Integrating ultrasound education and resources in order to bring ultrasound internationally for long-term development (BUILD) | 32 | 2 |
| Kurtis Orson Webster | Investigation of the sliding lung sign on embalmed cadaveric tissue: A teaching method for healthcare students | 33 | 2 |
| Jongyeol Kim | Incoming first year medical students' perception of ultrasound in medical education | 34 | 2 |
| Hamid Shokoohi | Curriculum module selection for ultrasound training in gross anatomy | 35 | 2 |
| Gregor Prosen | Sonographically-enhanced anatomy teaching in Maribor faculty of Medicine, Slovenia | 36 | 2 |
| Gregor Prosen | Introduction of WINFOCUS UltraSound Life Support pilot mentoring programme in Slovenia | 37 | 2 |
| Gregor Prosen | Sonographically-enhanced abdominal propedeutic classes in Medical School Maribor - and why Laennec, founder of fonendo-scope, was a true visionary! | 38 | 2 |
| Gina DiAntonio Swartzel | Incorporation of focused cardiac ultrasound skills training as part of the basic cardiac anatomy and physiology curriculum for medical students | 39 | 2 |
| Geoffrey Miller | A blended-learning, integrated ultrasonography curriculum for first-year medical students: Development, implementation and lessons learned | 40 | 2 |
| Donald Sussman | Creating the best ballistic gelatin formula as an initial component in the ultrasound training module for M1 anatomy students | 41 | 2 |
| Darab Zarrabi | Multispecialty Ultrasound Leadership Training Initiative (MULTI) | 42 | 2 |
| Creagh Boulger | Changing attitudes: The case for centralized ultrasound infrastructure | 43 | 2 |
| Creagh Boulger | The Ultrasound Challenge 2.0: Introducing inter-institution competition in medical student ultrasound education | 44 | 2 |
| Corby Makin | Ultrasound management and anatomy of distal radius fractures | 45 | 2 |
| Candace Broussard | An investment in the future: An ultrasound program for academically talented rising students in 9th-12th grades | 46 | 2 |
| Bryan Sloane | Medical student impression of ultrasound focused international volunteer experiences | 47 | 2 |
| Vaughan Lee | Family medicine accelerated track: Implementing ultrasound throughout a summer experience within an innovative curricular program | 48 | 2 |
| Sharon Schreiber | The silent tombs: A game for medical students to practice basic ultrasound diagnostic skills | 49 | 2 |
| Stefanie Duckett | Fostering andragogy ultrasound education utilizing student peer-to-peer mentoring | 50 | 2 |

FACULTY AND SPEAKER BIOS



Alfred Abuhamad, M.D., is professor and chairman for the Department of Obstetrics and Gynecology and associate dean for clinical affairs at Eastern Virginia Medical School in Norfolk, Va. He is on the board of the Society of Ultrasound in Medical Education,

vice-chair of the American Congress of Obstetrics and Gynecology Council on Patient Safety in Women's Health Care and on the executive committees of the International Society of Ultrasound in Obstetrics and Gynecology and the Society of Maternal-Fetal Medicine. In addition, he is the immediate past-president of the American Institute of Ultrasound in Medicine and the National Perinatal Quality Forum. He has published more than 100 peer reviewed manuscripts and has authored three textbooks in fetal echocardiography and office procedures.



David P. Bahner, M.D., RDMS, is professor of emergency medicine at the Ohio State University. Active in ultrasound education, he established an Ultrasound Academy at Ohio State with multiple opportunities for medical students, residents and faculty

to learn sonographic techniques in simulated environments and during clinical cases. He has been active at the national level serving as the inaugural emergency ultrasound section leader at the American Institute of Ultrasound in Medicine (AIUM) and the first emergency physician to sit on its Board of Governors. He is the inaugural chair of the AIUM's medical student ultrasound education interest group and champions the integration of ultrasound throughout medical school.



J. Oscar Barahona, BS, RDMS, is president and secretary of Greenwich Ultrasound Associates, PC, in Greenwich, Conn. Throughout his career, he has committed himself to the advancement of medical ultrasound.

He previously served as second vice president of the American Institute of Ultrasound in Medicine's (AIUM) executive committee and one year on AIUM's Board of Governors. In 2011, he was awarded AIUM's Distinguished Sonographer Award. He currently serves on the board of directors for the Society of Ultrasound in Medical Education and the American Registry for Diagnostic Medical Sonography.



Marcus Bastos, M.D., Ph.D., is head of the Department of Medical Clinic at the School of Medicine at Federal University of Juiz de Fora in Brazil. In addition, he serves as head of Nephrology at University Hospital of the Federal University of Juiz de Fora.

After completing medical school, residency and a doctoral program in Brazil, he trained as a fellow in nephrology at Royal Melbourne Hospital in Australia and as a postdoctoral fellow at Harvard Medical School in Boston.



Floyd E. Bell, M.D., "Tripp" is assistant professor in the Department of Radiology at the University of South Carolina School of Medicine. A graduate of the USC School of Medicine, he completed a transitional year internship at Spartanburg Regional

Medical Center in South Carolina and a diagnostic radiology residency at University of North Carolina Hospitals in Chapel Hill. He previously worked in private practice for a radiology group in Columbia, S.C. Among his research interests is ultrasound in medical education.



Beryl Benacerraf, M.D., is clinical professor of obstetrics, gynecology and reproductive biology and clinical professor of radiology at Harvard Medical School. Active in the ultrasound community, she is an elected fellow of the American College

of Radiology and the Society of Radiologists in Ultrasound. She previously served seven years as treasurer of the World Federation for Ultrasound in Medicine and Biology and two years as treasurer of the American Institute of Ultrasound in Medicine. Her contributions to the field of diagnostic ultrasound have been recognized by receipt of the Ian Donald Gold Medal of the International Society of Ultrasound in Obstetrics and Gynecology, the Frye Award and the Holmes award both of the American Institute of Ultrasound.



John B. Bennett, Ph.D., RVT, FICA, is curriculum coordinator and co-director of the Program for Medical Ultrasound at Wake Forest University School of Medicine in Winston-Salem, N.C. Prior to joining Wake Forest, he had been a frequent guest

lecturer and co-director of the program's post graduate CME course in neurovascular ultrasound. He has been a mentor to neurologists, vascular surgeons, cardiologists, residents and fellows interested in learning hemodynamics and ultrasound, both from within an academic medical center setting and as an applications and product consultant with manufacturers of ultrasound technology. His primary interests include: identification of the "at risk" carotid plaque; the ischemic limb; procedural ultrasound and the intraoperative assessment of vascular repairs.



Anjali Bhagra, MBBS, is a practicing internist at Mayo Clinic in Rochester, Minn. She is a trained radiologist from overseas and completed internal medicine residency at Mayo Clinic. Well-respected as a teacher and colleague, she has mentored many

students throughout her career. She has a keen interest in the implementation of point of care ultrasound, applying to the practice of internal medicine to provide cost effective, high quality and safe patient care.

FACULTY AND SPEAKER BIOS



Michael Blaivas, M.D., is a board-certified emergency medicine physician at a hospital outside of Atlanta. He is recognized as a pioneer in emergency and point-of-care ultrasound and has published more than 160 peer reviewed articles on point-of-

care ultrasound, edited several books and created multiple multi-media educational products. Along with his research interests, he has been active in multiple medical societies and is a founding member of the World Interactive Network For Critical Ultrasound (WINFOCUS) and Society of Ultrasound in Medical Education (SUSME), having served as president of both organizations. He takes an active role in building educational and policy-making relationships between societies in a variety of medical specialties throughout the world.



Erika L. Blanck, D.P.T., A.T.C., is a clinical assistant professor in the Department of Cell Biology and Anatomy at the University of South Carolina School of Medicine. In addition, she is the director of the School of Medicine's Gift of Body program and is one

of the core instructors for the human medical embryology and gross anatomy course taught at the School of Medicine. Her interests include ultrasound in medical and graduate education with an emphasis on sports medicine.



Noel T. Boaz, M.D., Ph.D., is director of the Laboratory of Biological Anthropology and Anatomy at the Integrative Centers for Science and Medicine in Martinsville, Va., and a research professor of anthropology at Virginia Commonwealth University. He has

taught at a number of institutions worldwide and is the author of numerous publications, including the textbook *Biology Anthropology, A Synthetic Approach to Human Evolution*, and *Evolving Health, The Origins of Illness and How the Modern World is Making Us Sick*. He is completing a forthcoming book on the evolutionary medicine of the male reproductive system (Oxford University Press). His interests in ultrasonography include didactic use in medical gross anatomy, clinical utilization in biometric health screening and research on distribution of adipose in human fat depots.



Raoul Breitkreutz, M.D., is a senior consultant and deputy chair of the Emergency Department of the city of Frankfurt, Germany. In addition, he serves as associate professor at University Hospital in Frankfurt. He founded a regional network

devoted to acute and critical care ultrasound www.sonoABCD.org with seven friends. Among his scientific interests are the design of strategies to implement focused ultrasound into clinical procedures and the integration of focused ultrasound into the universal ALS/ACLS and peri-resuscitation focused echo evaluation in life support, known as the FEEL protocol. He is deputy chair of emergency ultrasound of the German Society of Ultrasound in Medicine and was a founding member of WINFOCUS. He completed training in anesthesiology, internal and intensive care medicine.



Bernard E. Bulwer, M.D., MSc, FASE, is the first program director and associate professor of diagnostic medical sonography (echocardiography) at Massachusetts College of Pharmacy and Health Sciences University in Boston, and research associ-

ate in noninvasive cardiology/echocardiography at Brigham and Women's Hospital. A native of Belize, he was the 2002 recipient of the Lown International Fellowship in Cardiovascular Disease at the Brigham and Women's Hospital, Harvard Medical School. His research interests are point-of care echocardiography in medical education and global health, specifically screening protocols for rheumatic heart disease in school children. Dr. Bulwer is a prolific illustrator and coauthor in a number of leading textbooks and mobile apps, including his recent *Echocardiography Pocket Guide: The Transthoracic Examination*, a simulation guide for the performance and interpretation of the point-of-care echo exam.

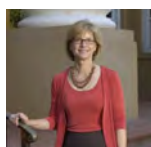

Judith T. Burgis, M.D., is the Edward J. Dennis, III, M.D., Professor and Chair of the Department of Obstetrics and Gynecology at the University of South Carolina School of Medicine. She is a graduate of the USC School of Medicine and completed an OB/

GYN residency at Richland Memorial Hospital. Her special interests are pediatric and adolescent gynecology, abnormal/cervical cytology, HPV, vulvar disorders, maternal morbidity and mortality, sexually transmitted diseases, abnormal bleeding and gynecologic ultrasound. She is an active member of the American College of Obstetricians and Gynecologists, the American Society for Colposcopy and Cervical Pathology, the North American Society for Pediatric and Gynecology, and the South Atlantic Association of Obstetricians and Gynecologists. She is also a member of the American Institute of Ultrasound in Medicine.

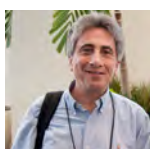

James Catroppo, M.D., is a clinical assistant professor in the Department of Pathology, Microbiology and Immunology at the University of South Carolina School of Medicine. He is deeply committed to teaching, medical education research initiatives

and educational leadership. Twice honored with awards for excellence in teaching by his students at USC, he serves as a faculty advisor and as a course director for medical pathology. He is developing virtual microscopy educational resources, including an online "virtual slidebox" library, for students. He has also developed and introduced ultrasound-pathology correlative lecture resources and clinical case-based learning resources for students into the medical pathology curriculum as well as the integrated ultrasound curriculum.

FACULTY AND SPEAKER BIOS



Shawn A. Chillag, M.D., is a professor and chairman of the Department of Internal Medicine at the University of South Carolina School of Medicine. He is heavily involved in medical student and internal medicine resident training at all levels. Special areas of additional training and expertise include geriatric medicine, pulmonary diseases and morning report along with a burgeoning interest in point of care ultrasound in the outpatient and inpatient arena. The majority of his scholarly activity has been case based and clinical reviews with some recent work in ultrasound. He believes use of bedside ultrasound as a powerful education and clinical tool for student and other trainee education is tremendously exciting and an area ripe for exploration.



Jim Connolly, MBBS, FRCS (Ed), FRCS (Glas) FCEM, CFEU, PgC, is an ED consultant in a busy major trauma centre in the North of England and uses ultrasound extensively in his everyday practice. He is currently the co-chair of the European Society of

Emergency Medicine (EuSEM) Ultrasound Group and vice chair of the UK College Emergency Medicine Ultrasound Group. He has published in this area and was co-author of a successful book "Ultrasound in Emergency Care," published by BMJ books (due for republication this year). He has lectured extensively nationally and internationally and both taught and innovated a large amount of courses directed at all levels of participants from paramedics through undergraduate to senior clinicians. His main interests are bedside ultrasound as it applies to the management of critically ill and cardiac arrested patients.



Matt Dawson, M.D., RDMS, RDCS, is medical director for point of care ultrasound at the University of Kentucky. He is the co-creator of the Ultrasound Podcast, which is downloaded more than 30,000 times per month. He is also co-author of Introduction to Bedside Ultrasound Volumes 1 & 2 available in iTunes, both currently having 100 percent, 5-star reviews. He is the co-creator of the One Minute Ultrasound smartphone app and Sonocloud.org. Within the last year he has been nationally recognized by the American College for Emergency Physicians for his contribution to emergency ultrasound education, received the Clerkship Directors in Emergency Medicine Innovation in Emergency Medicine Education Award, was awarded the National Excellence in Education award from the Academy of Emergency Ultrasound and was named Instructor of the Year at the University of Kentucky.



Anthony J. Dean, M.D., is the director of the Division of Emergency Ultrasound at the University of Pennsylvania. The division is responsible for emergency medicine resident training, a 1- and 2-year fellowship program, as well as training for pulmonary

critical care fellows and trauma critical care fellows at Penn, pediatric critical care fellows and pediatric emergency medicine fellows at the Children's Hospital of Philadelphia. Within the medical school, he teaches ultrasonography modules to

first-, second-, and fourth-year medical students and offers a four-week senior-year bedside ultrasonography elective. He also has a strong interest in international medicine. He is a founding member and on the Boards of WINFOCUS and PURE.



Diana Dowdy, MN, DNP, RDMS, is a certified nurse-midwife at the Clinic for Women, PA, in Huntsville, Ala. In addition, she serves as adjunct faculty at Vanderbilt University and the University of Alabama in Huntsville. She possesses more than

33 years of nurse-midwifery experience including full-scope midwifery, family planning, public health, management, graduate education and medical missions. She served three terms as President of the Alabama Affiliate of the American College of Nurse-Midwives (ACNM) and also sits on the ACNM National Committee on Ultrasound. She has served on the Joint Committee for Advanced Practice of the Alabama Boards of Nursing and Boards of Medical Examiners.



Mahmoud A. Elbarbary, M.D., Ph.D., MSc, EDIC, is a consultant pediatric intensivist in the Department of Cardiac Sciences at King Abdulaziz Cardiac Center in Riyadh, Saudi Arabia. He also serves as A/Professor of critical care medicine at King Saud

Bin Abdulaziz College of Medicine, the general secretary of the National & Gulf Center of Evidence Based Medicine and secretary general of the critical ultrasound training unit. His involvement in ultrasound includes serving as the chairperson of the guideline committee of WINFOCUS, member of the research committee, section editor of the Critical Ultrasound Journal and the director of PNCU (Pediatric & Neonatal Critical Ultrasound) courses. He has published several articles in the field of cardiac critical care, cytokine research, ultrasound, evidence based medicine and guidelines.



Kevin Evans, Ph.D., is associate professor at The Ohio State University College of Medicine and School of Health and Rehabilitation Sciences, where he works as a researcher and educator. In 2005, he established his own research lab where

extramural funded research is conducted examining the use of image analysis and sonographic contrast agents to enhance the detection of musculoskeletal disorders. He has secured more than \$800,000 in personal research funding including a basic science grant from the American Institute of Ultrasound in Medicine to continue his work with contrast media. He is the past-chair of the Board of Directors of the American Registry for Diagnostic Medical Sonography.

FACULTY AND SPEAKER BIOS



Robinson Ferre, M.D., is an emergency medicine physician fellowship trained in emergency ultrasound. He completed his residency training at Maine Medical Center in Portland, Maine and fellowship training

at Palmetto Health Richland Hospital in Columbia, S.C. He is an assistant professor in the Department of Emergency Medicine at Vanderbilt University, where he serves as the director of Emergency Ultrasound and the fellowship director for the Emergency Ultrasound Fellowship. Prior to completing an emergency ultrasound fellowship, he was a Major in the United States Air Force where he served as the emergency ultrasound director for the SAUSHEC Emergency Medicine Residency Program. He also completed two tours in Iraq with the 332 EMDG.



J. Christian (Chris) Fox, M.D., FAIUM, is professor of clinical emergency medicine and assistant dean of student affairs at the University of California, Irvine School of Medicine. In addition, he serves as director of instructional ultrasound. In 2010, he created a fully integrated four-year ultrasound curriculum at the school of medicine. A graduate of Tufts Medical School, he completed his residency training in emergency medicine at UC Irvine. After completing a fellowship in emergency ultrasound at Christ Hospital in Chicago, he joined the UC Irvine faculty in 2001.



William R. Fry, M.D., RVT, RDMS, FACS, is a professor of clinical surgery in the Department of Surgery at the University of South Carolina School of Medicine. He has been involved with ultrasound since his residency in the 1980s. Attending UT

Southwestern for medical school and Parkland Hospital for residency and a vascular fellowship, he developed a strong interest in anatomic and physiologic applications of ultrasound to patient care. He has been active in the development and teaching of the American College of Surgeons (ACS) educational programs in Ultrasound. As a member of the executive committee of the national ultrasound faculty for the ACS, he is the physician lead of converting the ACS basic ultrasound course to a web-based offering.



Matthew Garber, M.D., is currently the director of pediatric hospitalists at the Children's Hospital of Palmetto Health Richland and associate professor of pediatrics at the University of South Carolina School of Medicine. He has been a hospitalist for

13 years and is the medical director of the Value in Inpatient Pediatrics (VIP) network, a national quality improvement network. He created and directs the third-year medical student pediatric ultrasound curriculum and organized and presented ultrasound workshops for pediatric hospitalists nationally. In addition to being primary author for the ultrasound chapter in an upcoming textbook for pediatric hospitalists, he has co-authored a journal article and abstract on ultrasound in medical education.



Steven R. Goldstein, M.D., is a professor of obstetrics and gynecology at NYU Langone Medical Center. He is a Fellow of the American Institute of Ultrasound in Medicine and is currently President of this national organization. He serves as

the liaison physician from the American College of Obstetrics and Gynecology to the Women's Health Imaging Panel of the American College of Radiology. He is internationally known as a pioneer in transvaginal ultrasound, inventor of the Goldstein sonohysterography catheter, and author of the books "Endovaginal Ultrasound," "Ultrasound in Gynecology," and the soon to be released "Problem Solving in Gynecology Using Ultrasound."

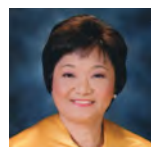

Maria Graciela Gonzaga, M.D., is a professor in the Departments of Medicine, Pharmacology and Clinical Epidemiology at the University of Santo Tomas in Manila, Philippines. She previously served as dean and assistant dean of the Faculty of

Medicine and Surgery and was chair of the University of Santo Tomas Hospital Institutional Review Board for 15 years. Twice elected as president of the Association of Philippine Medical Colleges Foundation Inc., she also served as president of the Philippine Society for Experimental and Clinical Pharmacology. She has served as peer reviewer for the Philippine Health Insurance Corporation; member of the Commission on Ethics of the Philippine Medical Association and member of the technical panel for medical education of the Commission for Higher Education.

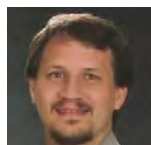

Craig Goodmurphy, Ph.D., is an associate professor in pathology and anatomy at Eastern Virginia Medical School where he is director of the Human Anatomy Lab, Clinical Anatomy & Surgical Training (CAST) Center and the plastination facility. He has

taught medical students for 20 years in Canada, the Caribbean and the United States. More recently, he developed the freely available www.AnatomyGuy.com website for vertically integrated education. The recipient of many teaching awards over the years, he was a finalist for the 2012 Virginia Outstanding Faculty Awards. He has been recognized for his community outreach as a recipient of the Hampton Roads Top 40 under 40 Award and the Virginia Beach school board Model Partnership Award for community involvement.

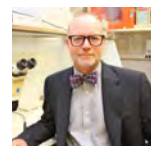

Rich Goodwin, Ph.D., is an associate professor in the Department of Cell Biology and Anatomy at the University of South Carolina School of Medicine. He also serves as the course director for the medical embryology and gross anatomy classes

and is the graduate director of the Biomedical Engineering Graduate Program. He received his Ph.D. from the University of South Carolina and then did his post-doctoral training at Vanderbilt University before returning to USC. His research includes the mechanisms of cardiovascular development, cardiac birth defects, and cardiovascular tissue engineering. Ultrasound technologies are an essential component of both his research efforts and medical education activities.

FACULTY AND SPEAKER BIOS



Carmela Graci, M.D., Ph.D., is the director of the WINFOCUS International Training Center of Niguarda Hospital in Milan, Italy. A graduate of the University of Milan School of Medicine, she trained as a general surgeon and critical care physician

and earned a doctorate degree in experimental and transplants surgery. She is a founding member of WINFOCUS and currently serves as general secretary of the organization and international faculty of the WINFOCUS Global UltraSound 4Human Development program in Brazil. She is regularly involved in ultrasound training and education for critical care doctors.



Deepak Govil, M.D., EDIC, FCCM, is associate director in the Institute of Critical Care and Anesthesiology at Medanta – The Medicity in Gurgaon, India. He is responsible for 22 beds in the gastroenterology and liver transplant intensive care unit.

He serves as vice president of the Indian Society of Critical Care Medicine. In addition, he is an examiner and teacher for Indian Diploma in Critical Care Medicine. He is on the board of WINFOCUS and has a keen interest in use of ultrasound in critical care and teaching bedside ultrasound to critical care fellows.



Young-Rock Ha, M.D., is an emergency medicine physician at Bundang Jesaeng Hospital in South Korea. He serves as an adjunct professor in the EMT department at Dongnam Health University. A certified critical care physician by the Korean

Society of Critical Care Medicine and certified physician for echocardiography by the Korean Society of Echocardiography, he is recognized internationally for his leadership in advancing ultrasound in Asia. He is chairman of WINFOCUS-Korea and WINFOCUS-Asia. His interest in ultrasound includes symptom-oriented sonographic approach for acute cardiopulmonary and abdominal complaints.



Jeff Hall, M.D., is an assistant professor in the Department of Family and Preventive Medicine at the University of South Carolina School of Medicine. He directs the department's maternity care curriculum, and also supervises several of the School of

Medicine's global health projects, including the M-4 student international electives, the traveler's health clinic, and a Global Health Fellowship program. He holds certificates in clinical tropical medicine (CTropMed) and travel health (CTH) and has lived and worked in Latin America, Asia, Africa, Europe and the United States. A graduate of the University of Florida School of Medicine, he completed a family medicine residency at St. Anthony Hospital in Oklahoma City in 2003.



Gregory L. Hays, M.D., is an emergency medicine physician at Henry Ford Hospital and a faculty member at the Henry Ford Hospital Ultrasound University. In addition, he serves as assistant clinical faculty at Wayne State University School of Medicine

and the assistant director of Henry Ford Hospital's Ultrasound Fellowship. His areas of interest and research include point-of-care ultrasound, health care disparities and innovations in resuscitation. A graduate of the University of Toledo College of Medicine, he completed residency training at St. Vincent Hospital in Toledo, Ohio.



Beatrice Hoffmann, M.D., Ph.D., RDMS, is an assistant professor in the Department of Emergency Medicine at Johns Hopkins Medical Institutes and director of emergency ultrasound and ultrasound fellowship training. She has authored several

manuscripts and book chapters on the topic of emergency ultrasound, lectured at national and international venues, and is the founder and editor of the educational emergency ultrasound website of the American College of Emergency Physicians (www.sonoguide.com) for which she received the national ACEP Ultrasound Section Award in 2008. She is the current chair of the Ultrasound Section of the Society of Academic Emergency Medicine and was elected corresponding member of the German Society of Ultrasound in Medicine (DEGUM).



Richard A. Hoppmann, M.D., FACP, is professor of medicine and dean of the University of South Carolina School of Medicine. He is director of the Ultrasound Institute at USC and principle investigator on multiple ultrasound grants. He has introduced an integrated ultrasound curriculum (iUSC) over four

years of medical student education and has helped develop an ultrasound training program for primary care physicians in rural South Carolina. He is well published in the area of ultrasound education. As founder and the first President of the Society of Ultrasound in Medical Education, he has played an instrumental role in advancing ultrasound in medical education throughout the world.



Duncan Howe, Ph.D., is coordinator of ultrasound programs at the University of South Carolina School of Medicine's Ultrasound Institute, a position he has held for the last five years. He has worked with the Ultrasound Institute staff to develop

and implement training programs in point-of-care ultrasound for medical students, primary care residents and faculty, rural providers, Free Clinic providers and paramedics. Prior to this, he worked with the USC School of Medicine's Department of Family Medicine to coordinate community health and student education programs in primary care centers in rural South Carolina and was the medical physicist for the USC School of Medicine's Department of Radiology.

FACULTY AND SPEAKER BIOS



Arif Hussain, M.D., is the head of cardiac critical care and a consultant in cardiac anesthesia in King Abdulaziz Cardiac Center in Riyadh, Saudi Arabia. His practice includes care of both adult and pediatric patients.

His passion for ultrasound began when transesophageal echocardiography was introduced to cardiac operating rooms. Now with a broader total body application of ultrasound, he has advocated its use in daily practice for better care of any patient. He regularly teaches courses in echocardiography for WINFOCUS.



Allison Jackson, M.D., is instructor of clinical obstetrics and gynecology and assistant clerkship director at the University of South Carolina School of Medicine. Prior to her appointment in 2011, she completed a four-year residency at Carolinas Medical

Center. Her areas of interest include minimally invasive surgery and resident and student teaching. She is the recipient of the Ronald Pixley Excellence in Research Award.

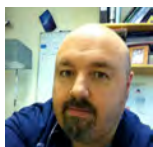

Bob Jarman, MBBS, FRCS, FCEM, CFEU, PgD, is a specialist in emergency medicine based in Gateshead in the United Kingdom. He developed an interest in point of care ultrasound more than 10 years ago and regularly uses point of care ultrasound in

his clinical practice. Additionally, he works with the University of Teesside in Middlesbrough, England and helped establish the first accredited point-of-care ultrasound masters post-graduate program in the United Kingdom. He serves as chair of the College of Emergency Medicine (UK) Ultrasound Subcommittee, vice chair of the International Federation of Emergency Medicine (IFEM) Emergency Ultrasound Subcommittee, lead author and project lead for IFEM point of care ultrasound curriculum guidelines and is a council member of the British Medical Ultrasound Society.



Gurjit Singh Kaeley, MBBS, MRCP, is board certified in internal medicine and rheumatology and serves as Division Chief, Associate Professor of Medicine, and Program Director for Rheumatology Fellowship and Program Director for Musculoskeletal Ultra-

sound at the University of Florida College of Medicine in Jacksonville. He is passionate about musculoskeletal ultrasound and has directed many sonographic courses including the American College of Rheumatology Intermediate Musculoskeletal Ultrasound courses. His research interests include the use of ultrasound for the evaluation of inflammatory and crystal-line arthropathies, regional pain disorders and sonographic training of rheumatologists. Educational interests include hybrid e-learning in postgraduate rheumatology education. He was the founding president of the Ultrasound School of North American Rheumatologists.



Keith Killu M.D., RDMS, RDCS, is an assistant clinical professor in medicine and critical care, director of Henry Ford Ultrasound University and research director for the surgical intensive care unit at Henry Ford Hospital in Detroit. He is a board member

for the Society of Ultrasound in Medical Education. In addition to publishing multiple papers on ultrasound research in peer review journals, he has authored two ultrasound books and chapters. He completed residency training at Michigan State University and joined Mount Sinai Medical Center in New York for his fellowship training in critical care.



Jongyeol Kim, M.D., is associate professor of neurology and the Medical Director of The F. Marie Hall SimLife Center at Texas Tech University Health Sciences Center (TTUHSC). After his fellowship in cerebrovascular disease, he remained on faculty

for four years at Wake Forest University School of Medicine. He holds the positions of Covenant Health System Endowed Chair in Cerebrovascular Disease, Head of Section on Stroke and Cerebrovascular Disease, and Medical Director of the Primary Stroke Program at University Medical Center in Lubbock, Texas. He initiated the ultrasound program at TTUHSC in 2011 and was granted with an educational fund for the integration of longitudinal ultrasound curriculum into medical education. He is currently in charge of implementation of ultrasound and simulation to the medical curriculum.

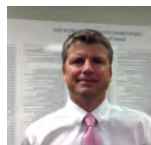

Barry J. Knapp, M.D., RDMS, FACEP, is coordinator of ultrasound education programs for Eastern Virginia Medical School (EVMS) where he has been involved in both graduate and undergraduate medical education for the past 15 years. Among

numerous other roles, he serves as the residency program director for the EVMS Department of Emergency Medicine. He is the founder and former director of the EVMS Emergency Medicine Ultrasound Fellowship. He is board certified by the American Board of Emergency Medicine and has extensive firsthand experience teaching ultrasound to students, residents and medical staff.



Debra E. Krotish, Ph.D., is the director for research and grants for the Ultrasound Institute at the University of South Carolina School of Medicine. She also serves as executive director for SeniorSMART, a Center for Economic Excellence for the state of

South Carolina. Her main interests are undergraduate medical education in ultrasound and continuing medical education.

FACULTY AND SPEAKER BIOS



Jean-François Lanctôt, M.D., is an attending physician at the Charles-Lemoyne Hospital emergency department and in the intensive care unit of Verdun Hospital in Montreal, Canada. He teaches at McGill and Sherbrooke Universities. His main

areas of interest include development of bedside ultrasound teaching in the context of resuscitation. He is the co-founder of the echo guided life support (EGLS) course and co-developer of the iOS application « Shock Echo ».



Vaughan H. Lee, Ph.D., is associate professor of cell biology and biochemistry at Texas Tech University Health Sciences Center (TTUHSC) in Lubbock, Texas. In 2012, he was appointed as the Dr. Bernell Dalley Endowed Professor of Medical

Education at Texas Tech. Recognized for his contributions to education, he was awarded the TTUHSC President's Excellence in Teaching Award and the Dean's Basic Science Teaching Award in 2008. He is a member of the Society for Ultrasound in Medical Education, the American Association of Anatomist and the International Association of Medical School Educators. His scholarly interests include developing and promoting innovations in anatomical education for undergraduate medical students.



Alexander B. Levitov, M.D., FCCM, FCCP, RDSCS, is a professor in the Division of Pulmonary and Critical Care Medicine and director of the Ultrasound Training Program at Eastern Virginia Medical School. He is

board certified in internal medicine and critical care medicine and a registered diagnostic cardiac sonographer. Recognized nationally and internationally as an expert in bedside ultrasound, he received the Presidential Citation for Outstanding Contributions from the Society of Critical Care Medicine. He is a visiting professor at Harvard Medical School, Goethe University in Frankfurt, Germany and Yangzhou University in China. In addition, he directs several certified medical education ultrasound courses in the United States and internationally.



Margaret Lewis, M.D., is a faculty member at Carolinas HealthCare System. She received her Bachelor of Science degree in chemical engineering from the University of South Carolina in 2002. She completed medical school in 2008 and emergency

medicine residency in 2011, both at the Medical University of South Carolina in Charleston. She then completed an emergency ultrasound fellowship at Carolinas Medical Center in 2012 and joined CMC as ultrasound faculty. Her focuses include ultrasound in medical student education, resident education, remote education, as well as international medicine.



Daniel Lichtenstein, M.D., is a medical intensivist working at Ambroise-Paré Hospital in Paris-West, France since 1989. His main contributions to ultrasound include defining critical ultrasound as a tool for intensivists, contributing to five

editions of a critical ultrasound textbook since 1992 (Springer) and writing more than two dozen articles in international journals focused primarily on lung and venous ultrasound. He is president of Cercle Des Echographistes D'Urgence et de Reanimation Francophones (CEURF), a non-profit association aiming at promoting using information and training the use of ultrasound devoted to the intensive care and emergency medicine. Through CEURF, he is involved in a personalized training center at the bedside in the intensive care unit.



Yiju Teresa Liu, M.D., RDMS, is an assistant professor of emergency medicine and emergency ultrasound fellowship director at George Washington University. She is past chair of the Society for Academic Emergency Medicine's Academy of Emer-

gency Ultrasound Medical Student Education subcommittee. She leads ultrasound education at George Washington School of Medicine, where clinician performed ultrasound is integrated into both pre-clinical and clinical curricula. An enthusiast in bedside ultrasound, she has been teaching and speaking about ultrasound both nationally and internationally and has published several articles on bedside ultrasound in peer reviewed journals.

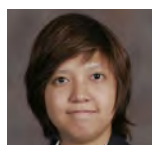

Suthaporn Lumlertgul, M.D., is an emergency physician at King Chulalongkorn Memorial Hospital in Bangkok, Thailand and director of WINFOCUS Thailand. She has been working on ultrasound in emergency and critical care since 2009 and teaching

internationally. She conducted an annual international course on ultrasound guided cadaver in Thailand. Her interest is ultrasound guided procedures teaching novice and hemodynamic resuscitation using ultrasound.



Mike Mallin, M.D., is the director of the emergency ultrasound division and the emergency ultrasound fellowship at the University of Utah. He is co-creator of the Ultrasound Podcast —downloaded more than 500,000 times in over 180 countries,

the One Minute Ultrasound smartphone app, and Sonocloud.org. In 2012 he was nationally recognized by the American College of Emergency Physicians for his contribution to emergency ultrasound education. He was also given the Academy of Emergency Ultrasound Education Award at the 2013 annual meeting of the Society of Academic Emergency Medicine and has been awarded Emergency Medicine Attending of the Year at the University of Utah in both 2011 and 2013.

FACULTY AND SPEAKER BIOS



Lawrence A. Melniker, M.D., is vice chair of continuous quality management in the Department of Emergency Medicine at New York Methodist Hospital and assistant clinical professor in the Department of Medicine at Weill Medical College, Cornell

University. He serves on the board of directors for WINFOCUS and the editorial board for the Critical Ultrasound Journal. In addition, he serves on the research committees for the International Federation of Emergency Medicine and American College of Emergency Physicians. His interests include clinical ultrasonography, quality management, outcomes research and educational medical informatics.



Joseph Minardi, M.D., is director of emergency ultrasound at West Virginia University in Morgantown, W.V., where he also serves as the Emergency Ultrasound Fellowship Director and directs a longitudinal curriculum for ultrasound in the M.D.

program at the West Virginia School of Medicine. In addition, he is the clinical preceptor for a fourth year elective rotation in emergency and clinical ultrasound. His research and professional interests include ultrasound education and skill mastery, particularly for novice sonographers and medical students.



Jenny Mladenovic, M.D., MBA, MACP, is provost and vice president for academic affairs at Oregon Health & Science University. She has more than 25 years of experience in academic administration, having held positions as Chair or Chief of the Department

of Medicine, Dean for Education, faculty and hospital affiliations, and director of research education and career development. Nationally, she has served as a member of the Board of Directors of the American Board of Internal Medicine, its Executive Committee, and has chaired the Examination Committees in Internal Medicine. She has also been active as a member of the American Board of Medical Specialties, the Association of Professors of Medicine and its Board, and the American Society of Hematology, and the Accreditation Council for Graduate Medical Education.



Miguel Montorfano, M.D., is the coordinator of Critical Ultrasound Education and chair of the Ultrasound Unit in the Emergency Hospital of Rosario, Argentina. He is member of the board of Certification and Recertification in Ultrasound and Echo Doppler

at the Medical College of Rosario. In addition, he is founding member and past president of the Ultrasound Society of Rosario and past vice president of the Argentina Federation of Societies of Ultrasound and Echo Doppler. He has authored two books on ultrasound and several chapters and articles of the specialty. He has been involved in the organization of training courses and national and international congresses on ultrasound during the past 20 years. He is currently the coordinator of WINFOCUS Latinoamerica.



Bret Nelson, M.D., RDMS, FACEP, is associate professor of emergency medicine and director of emergency ultrasound at Mount Sinai School of Medicine in New York. He has lectured on ultrasound throughout the world and is chief editor of the ultrasound

education website, www.SinaiEM.us. He is coauthor of the Manual of Emergency and Critical Care Ultrasound as well as the Emergency Medicine Oral Board Review Illustrated (Cambridge University Press). A member of several ultrasound organizations, he serves as vice-chair of the American Institute of Ultrasound in Medicine Emergency and Critical Care Community of Practice, WINFOCUS' Board of Directors and national faculty of the American College of Chest Physicians' ultrasonography course and The Difficult Airway Course. He is a recipient of the American College of Emergency Physicians' National Faculty Teaching Award.



Professor Luca Neri is global director and past president of WINFOCUS (World Interactive Network Focused On Critical UltraSound) USCME. His responsibilities include taking care of the international development of WINFOCUS training, scientific

and humanitarian activities, travelling, lecturing and networking throughout dozens of countries every year. He is trained as an emergency surgeon and critical care physician. Apart from being managing editor of the Critical Ultrasound Journal, he holds office as Critical Ultrasound Program Director in the Pre-hospital EMS/HEMS of 'Niguarda Ca' Granda' Hospital-AREU in Milan, Italy.



Francis H. Neuffer, M.D., is chair of the Department of Radiology at the University of South Carolina School of Medicine. He joined the department in 2003 and directs the radiology education of undergraduate medical classes throughout the four-year

curriculum. He is a member of the Association of University Radiologist and the Radiological Society of North America. A graduate of the Medical University of South Carolina, he completed a radiology residency at the University of South Alabama.

FACULTY AND SPEAKER BIOS



Harvey L. Nisenbaum, M.D., FACR, FAIUM, FSRU, is associate professor of radiology at University of Pennsylvania Perelman School of Medicine and is chairman of the Department of Medical Imaging at Penn Presbyterian Medical Center in Philadelphia. He is

currently President-Elect of the World Federation for Ultrasound in Medicine and Biology (WFUMB-<http://www.wfumb.org>). WFUMB is a federation of six organizations: AIUM, AFSUMB, ASUM, EFSUMB, FLAUS, and MASU. With more than 50,000 members in more than 50 countries, WFUMB is dedicated to the advancement of ultrasound by encouraging research, promoting international cooperation, disseminating scientific information, and improving communication and understanding in the world community using ultrasound in medicine and biology. He previously served as President of the American Institute of Ultrasound in Medicine (AIUM), Pennsylvania Radiological Society, Philadelphia Roentgen Ray Society and the Greater Delaware Valley Ultrasound Society.



Vicki E. Noble, M.D., is director of the Division of Emergency Ultrasound at Massachusetts General Hospital, a program she founded in 2003. A graduate of the Harvard Affiliated Emergency Medicine Residency program in Boston, she completed a

one-year fellowship in emergency ultrasound at St. Luke's-Roosevelt Hospital in New York. She is active in the American College of Emergency Physicians, the American Institute of Ultrasound in Medicine and WINFOCUS. Her research interests include lung ultrasound, and she is working with the Massachusetts Institute of Technology Lincoln Laboratories to develop decision support software for lung sonography. She has also been active in research looking at the comparative effectiveness of point of care ultrasound.



Paula Nocera, M.D., MBA, DESA, is one of the founders and coordinator of WINFOCUS Sao Paulo and works as a consultant anesthesiologist in private hospitals in Sao Paulo, Brazil. She is attending a postgraduate program in regional anesthesia and

nerve blocks at SÍrio Libanês Hospital in Sao Paulo. In addition, she is developing a postgraduate research project related to ultrasound in medical education at University of Campinas. She graduated and completed residency in anesthesiology from the University of Campinas-Brazil and completed a fellowship in cardiovascular anesthesia and intensive care in Strasbourg, France.



Ramon Nogué, M.D., is professor of emergency medicine and director of postgraduate training in emergency medicine and emergency and critical ultrasound at the University of Lleida School of Medicine in Spain. He serves as coordinator for Spain's

ultrasound training program in the Spanish Society of Emergency Medicine. He is coordinator of WINFOCUS Spain and previously served as president of the 8th WINFOCUS World Congress in Barcelona in Oct. 2012. A director and teacher of several basic and advanced courses in emergency ultrasound, he authored the Manual of Emergency Ultrasound — practical guide in Spanish. His research interests include transthoracic echocardiography, lung ultrasound and multigoal ultrasound approach in the emergency critical patient.



Valerie Dean O'Loughlin, Ph.D., is an associate professor of anatomy at Indiana University School of Medicine, where she teaches human gross anatomy to medical students, basic human anatomy to undergraduates, and mentors masters and

doctorate students pursuing anatomy education research. She is the acting president of the Human Anatomy and Physiology Society (HAPS) and is active in the American Association of Anatomists. She is currently a co-author on the McKinley/O'Loughlin: Human Anatomy textbook and the McKinley/O'Loughlin/Bidle Human Anatomy and Physiology textbook. Her undergraduate degree is from the College of William and Mary, and her doctorate degree in biological anthropology is from Indiana University.



Abdulmunhem Obaideen, M.D., is a senior consultant radiologist, a clinical radiologist, associate professor and radiology educator at the College of Medicine – University of Sharjah in the United Arab Emirates. He has a special interest in pediatric clinical ultrasound, and he had organized several courses and workshops on ultrasound at the Centre of Clinical Training at the University of Sharjah. A believer that ultrasound may be

the future doctor's stethoscope in many specialties if they had good structured training program, he is part of a multidisciplinary team from the faculty of medicine working on a unique project in the Middle East to introduced ultrasound education to undergraduate medical students.



Adi Osman, M.D., is a consultant emergency physician and head of the Department of Trauma & Emergency at Hospital Raja Permaisuri Bainun in Ipoh, Perak, Malaysia. He is a fellow of emergency critical care and critical ultrasound from the WINFOCUS

International Fellowship Program. He serves as chairman for emergency critical care and critical ultrasound subcommittee in the College of Emergency Physician, Academy of Medicine Malaysia. A coordinator of WINFOCUS-Malaysia, he is currently serving as president of the Society of Emergency and Critical Sonography Malaysia.

FACULTY AND SPEAKER BIOS



James Palma, M.D., MPH, is a Commander in the Medical Corps of the United States Navy and assistant professor at the Uniformed Services University of the Health Sciences in Bethesda, Md. As the university's first Director of Ultrasound in

Medical Education, he has developed and implemented a new integrated ultrasound curriculum for the medical school, and he is active in ultrasound teaching and program development throughout the military and civilian sectors. His research interests include bedside ultrasound and medical education. He previously served for two years as the General Medical Officer on the aircraft carrier USS George Washington (CVN-73). He was a staff emergency medicine physician for two years at the Naval Hospital Yokosuka, Japan, and a visiting assistant professor at Keio University in Tokyo.



Jose Pazeli, Jr., M.D., is an intensivist and nephrologist as well as a professor at the School of Medicine of Barbacena in Minas Gerais, Brazil. He is coordinator of the critical care unit and associate director of the dialysis unit at Santa Casa de Misericórdia

Hospital in Barbacena. Active in ultrasound education, he organizes ultrasound courses in the critically ill and nephrology patients and serves as manager of WINFOCUS/Brazil and the Ecos dos Gerais Project.



Daniel Pedrollo, M.D., is an attending physician in the trauma room and assistant of the emergency residency program at Hospital de Pronto Socorro Porto Alegre in Brazil. In addition, he works as an attending physician in the emergency department

at Hospital de Clínicas de Porto Alegre in Brazil. He graduated from the first residency program in emergency medicine in Brazil. He works for the recognition of emergency medicine in Brazil as a specialty and is a founding member of the Brazilian Emergency Medicine Society and organized the first national conference of emergency medicine. He has been a member of WINFOCUS since 2006 and was involved in the organization's 4th WINFOCUS World Congress in Porto Alegre, Brazil.



John S. Pellerito, M.D., FACR, FSRU, FAI-UM, is associate professor of radiology at Hofstra North Shore-LIJ School of Medicine. He is associate chairman of strategic planning and technology, chief of the Division of Ultrasound, CT and MRI and director of

the Peripheral Vascular Laboratory at North Shore University Hospital in Manhasset, New York. In addition, he serves as director of the Body Imaging Fellowship Program. His interests include new imaging technologies and approaches to the diagnosis of vascular and oncologic diseases. He serves on the board of the Intersocietal Accreditation Commission for the Accreditation of Vascular Laboratories and multiple committees for the American Institute of Ultrasound in Medicine (AIUM). He is a fellow of the American College of Radiology, Society of Radiologists in Ultrasound and AIUM.



Philippe Pès, M.D., is an emergency medicine physician at SAMU 44 CHU de Nantes in France. In addition, he serves as the Emergency Ultrasound Section coordinator for the west region of France and is a co-founding member and treasurer of WINFOCUS-France.



Tomislav Petrovic, M.D., is an emergency physician at SAMU 93 Hôpital Avicenne in France. At the hospital, he chairs the emergency ultrasound education section. He is president of WINFOCUS-France and past-president of WINFOCUS.



Mary Beth Poston, M.D., is associate professor of clinical internal medicine and Internal Medicine Residency Program Director at the University of South Carolina School of Medicine. A graduate of the USC School of Medicine, she also completed

residency and a fellowship at USC. Her academic interests include pre-clinical medical student education, ultrasound in medical education and increasing physical activity in primary care.



Gregor Prosen, M.D., is faculty of health sciences at the University of Maribor, Slovenia. He teaches in the Department of Physiology and Department of Emergency Medicine.

A founding member and current president of Medical Society WINFOCUS Slovenija, he has been instrumental in bringing point-of-care ultrasound in emergency medicine to Slovenija. He is an instructor in WINFOCUS Life Support Course and a member of the educational committee of WINFOCUS.



Radovan Radonic, M.D., Ph.D., is a professor at the University of Zagreb School of Medicine in Croatia. In addition, he serves as an internist in the intensive care unit at University Hospital Center Zagreb where he uses ultrasound for diagnostic purposes on a daily basis. From 1993 to 2006, he was secretary of the Croatian Society of Intensive Care Medicine. He is a member of WINFOCUS and serves on the WINFOCUS Board of Directors.

FACULTY AND SPEAKER BIOS



Victor V. Rao, MBBS, DMRD, RDMS, is the director of ultrasound education at the University Of South Carolina School Of Medicine. He has also worked in mission hospitals and has a wide clinical exposure including internal medicine, surgery, OB/

GYN, dermatology and radiology. His passion is ultrasound and he loves teaching ultrasound and is currently involved in training medical students, physicians, nurse practitioners, EMTs, nurse anesthetists and in various other specialties as well as primary care physicians in diagnostic ultrasound and ultrasound guided procedures. He also has been involved in clinical research in the use of high intensity focused ultrasound to treat BPH and prostate cancer in human subjects in the United States. He has several publications and posters and also developed the online ultrasound learning modules for the Society of Ultrasound in Medical Education website.



Souvik Sen, M.D., MS, MPH, is professor and chair of the Department of Neurology at the University of South Carolina School of Medicine and the Center of Economic Excellence Stroke Chair at the University of South Carolina. Sen is a Fellow of the

American Heart Association and most recently served on the committee for Thoracic Aortic Disease guidelines sponsored by the American College of Cardiology and the American Heart Association. He is board certified in neurology and board certified in the vascular neurology sub-specialty. Sen has published several peer-reviewed articles, book chapters.



Osborne Shuler, M.D., is an associate professor in the Department of Pediatrics at the University of South Carolina School of Medicine. He is the vice chairman for clinical affairs of the department and director of the Division of Pediatric Cardiology.

He received his medical education and post graduate training from the Medical University of South Carolina. His areas of expertise are general pediatric cardiology and fetal cardiology. He is medical director of pediatric echocardiography for Palmetto Health Children's Hospital in Columbia, SC.



Richard R. Sikou, MLA, FSL, "Rick" is the operational director of the Virginia State Anatomical Program. Previously he was chair of the Department of Funeral Services and Health Sciences at John Tyler Community College in Chester, Va. He is also a

per diem team leader, procurement technician and serves as an embalming consultant on tissue and organ procurement cases for LifeNet Health. He has more than 30 years of experience in embalming and preservation techniques. With this background, he has been instrumental, along with Dr. Noel Boaz and his staff at VSAP, in developing alternative methods of tissue preservation for anatomical dissection and research. Most notably the "soft embalming" process which is based on the "Thiel Method."



Kerry Sims, M.D., is assistant professor of clinical obstetrics and gynecology at the University of South Carolina School of Medicine. In addition to her comprehensive obstetric and gynecologic practice at University Specialty Clinics, she serves as

an attending physician in the labor and delivery and surgery units at Palmetto Health Richland Hospital and is the clerkship director for USC medical students. Her specialty interests include gynecologic ultrasound, medical education and breast-feeding education.



R. Stephen Smith, M.D., RDMS, FACS, is chair of the Department of Surgery at the University of South Carolina School of Medicine. He is a nationally recognized trauma surgeon, with an accomplished career in both medicine and military service. He has

authored more than 95 peer-reviewed journal articles, 22 book chapters, and numerous multimedia publications and has given more than 430 lectures nationally and internationally. In 2006, he retired as Captain in the United States Naval Reserve Medical Corps. His surgical expertise includes trauma, critical care, emergency and general surgery. His recent research interests include surgical ultrasound, chest wall injury and thoracic trauma, and novel methods for correction of hyperglycemia in injured patients. Additionally, he has been involved nationally and internationally in advancing the use of ultrasound in several surgical specialties and served as the Chair of the American College of Surgeons National Ultrasound Faculty for five years.



Dave Spear, M.D., is an attending physician and pediatric emergency medicine ultrasound director at Children's Medical Center in Dallas. As an associate professor in the Department of Surgery at the University of Texas Southwestern Medical Center, he

has a dual duty in training the emergency medicine residents at Parkland Hospital and the pediatric emergency fellows at Dallas Children's. With his expertise in emergency ultrasound, he is continually developing innovations in pediatric emergency ultrasound. His goal is to develop the use of ultrasound on a variety of different applications including vascular access as well as emergency ultrasound in trauma and critically ill children.



Enrico Storti, M.D., is a Consultant at the 1st Department of Anesthesia and Intensive Care, Niguarda Cà Granda Hospital in Milan, Italy. He is founding member of WINFOCUS and has served as president of the association since Nov. 2012. As WIN-

FOCUS Education Global co-director, he is regularly involved with ultrasound training and education all over the world. He is a member of the Advisory Board of Ultrasound University at Henry Ford Hospital in Detroit. He serves as assistant editor of the Critical UltraSound Journal and authors publications and textbook chapters in the field of critical care ultrasound. Among his education and research interests are airway management, lung ultrasound and focused echocardiography in critical care pre-hospital ultrasound.

FACULTY AND SPEAKER BIOS



Bee Giok K. Tan-Sales, M.D., MBAH, FAC-SM, CCD, is associate professor and chairman of Rehabilitation Medicine and section chief of ultrasound laboratory for Faculty of Medicine and Surgery at the University of Santo Tomas (UST) in the Philippines. She

is section chief of Physical Rehabilitation and Sports Medicine Section of San Juan de Dios Hospital Educational Foundation, Inc. A certified clinical densitometrist, she is the section chief of Cardinal Santos Medical Center, Section of BMD Bone Check Center. She has an interest in musculoskeletal ultrasound and has been instrumental in establishing ultrasound integration in medical education and its skill laboratory at UST Faculty of Medicine and Surgery; as such, she is directly responsible in organizing training sessions and participates in the ultrasound integration curriculum planning.



Ee Tay, M.D., FAAP, is an assistant professor in the Department of Pediatrics and Department of Emergency Medicine at Ichan School of Medicine at Mount Sinai in New York City. She completed both her pediatric residency and pediatric emergency medicine fellowship at Children's Hospital at Montefiore in Bronx, New York. After working as an attending for several years, she returned to fellowship in pediatric emergency medicine ultrasound at Mount Sinai. Her current academic and research interests include lung, appendix, and soft tissue ultrasounds, pediatric dermatology and visual diagnoses and medical photography in the pediatric emergency department.

covering various topics from resuscitation, procedures and the lung. He is also the chair of the Pediatric Committee for WINFOCUS, section editor for the Critical Ultrasound Journal on point-of-care ultrasound and serves on the editorial advisory board for the Journal of Ultrasound in Medicine. He has led international pediatric point-of-care ultrasound workshops for WINFOCUS World Congresses since 2006 including subsequent annual editions of the meeting, as well as pediatric ultrasound workshops and lectures at the American Institute of Ultrasound in Medicine's annual meetings.

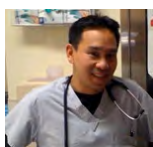

Jim Tsung, M.D., MPH, is an associate professor of emergency medicine and an associate professor of pediatrics at the Icahn School of Medicine at Mount Sinai. He has authored papers pioneering the use of point-of-care ultrasound in children

covering various topics from resuscitation, procedures and the lung. He is also the chair of the Pediatric Committee for WINFOCUS, section editor for the Critical Ultrasound Journal on point-of-care ultrasound and serves on the editorial advisory board for the Journal of Ultrasound in Medicine. He has led international pediatric point-of-care ultrasound workshops for WINFOCUS World Congresses since 2006 including subsequent annual editions of the meeting, as well as pediatric ultrasound workshops and lectures at the American Institute of Ultrasound in Medicine's annual meetings.



Rajesh Vakani, M.D., is an assistant professor of internal medicine at the University of South Carolina School of Medicine, director of the heart failure program at the Dorn VA Medical Center and a cardiologist practicing in Columbia, S.C. In addition,

he is associate chief for non-invasive cardiology at Dorn VA Medical Center. He has a particular interest in ultrasound and ultrasound related education. He holds board certification in cardiology, echocardiography, nuclear medicine, internal medicine and pediatrics. He is involved in multiple clinical research projects and is active in medical education at various levels including medical students at medical school and resident education at the hospital. At Albany Medical College in

Albany, N.Y., he received his cardiovascular fellowship training and his internal medicine and pediatrics training. He received his medical degree from the University of Buffalo in N.Y.



Maxime Valois, M.D., is an attending physician in the emergency department of Charles-LeMoyne Hospital and the intensive care unit of Verdun Hospital in Montréal, Canada. His appointments include roles as associate professor at Montreal,

Sherbrooke and McGill Universities. He is one of the founders of the Echo-Guided Life Support course and is a regional director of the Canadian Emergency Ultrasound Society. His interests include critical care, development of electronic templates (co-developer of the « shock echo » iOS application) and point-of-care ultrasound research and education.



Gabriele Via, M.D., is an intensivist and consultant for the 1st Department of Anesthesia and Intensive Care, IRCCS Policlinico San Matteo Foundation in Pavia, Italy. He is a founding member of WINFOCUS, director of the WINFOCUS Critical Care Echo

Global Training Program and director of the WINFOCUS Pavia International Training Center. In addition, he is international faculty of the WINFOCUS US-Basic and US-Advanced Life Support courses. He is co-director of the annual Echocardiography for Intensivists and Emergency Medicine Clinicians course at Harvard Medical School in Boston. An author and co-author of peer-reviewed publications and textbooks chapters in the field of critical care ultrasound, his main education and research interests include transthoracic and transesophageal echocardiography and lung ultrasound in the critical patient.

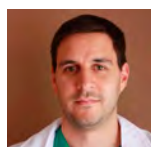

Tomas Villen, M.D., is an attending physician and former emergency ultrasound division director at Hospital Universitario Ramon y Cajal in Madrid. He is a fellow of emergency ultrasound from Massachusetts General Hospital in Boston. A member

of the Board of Directors of WINFOCUS, he also serves as secretary of the Ultrasound Section in the Spanish Society for Emergency Medicine.



Giovanni Volpicelli, M.D., FCCP, is an emergency physician at San Luigi Gonzaga University Hospital in Torino, Italy. He is associate editor of the Critical Ultrasound Journal, a member of the editorial board and a reviewer of international journals

in the field of emergency medicine and emergency ultrasound. He directs the WINFOCUS Lung Ultrasound Group and coordinates the international program of education on lung ultrasound. Previously, he served as chairman of the scientific committee of the 1st International Consensus Conference on Lung Ultrasound. An author of chapters in international books of emergency medicine and emergency ultrasound, he has more than 50 indexed publications in international peer-reviewed journals with more than 500 citations.

FACULTY AND SPEAKER BIOS

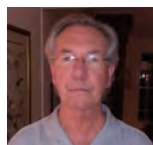

James R. Wells, M.D., FACS, is a research professor in the Department of Cell Biology and Anatomy at the University of South Carolina School of Medicine. He teaches medical students and surgery residents in clinical otolaryngology at Dorn Veterans

Administration Medical Center (VAMC) in Columbia, S.C., where he serves as Division Chief. He has been a Fellow of the American College of Surgery since 1991 and is the chairman of the Cancer Committee at Dorn VAMC. His medical interests include polymer preservation and the integration of gross anatomy into the four-year medical curriculum.

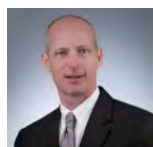

W. Randal Westerkam, M.D., is an assistant professor in the Department of Orthopaedics and Sports Medicine at the University of South Carolina School of Medicine. Prior to joining USC, he practiced rehabilitation medicine in a private group

in Columbia, S.C. He is a graduate of the University of North Carolina School of Medicine in Chapel Hill and completed his residency in Physical Medicine and Rehabilitation at the Medical College of Virginia. He is board certified in PM&R and Sports Medicine. He has an avid interest in the use of point of care ultrasound in the diagnosis of musculoskeletal injuries and guided sports medicine procedures. Additionally, he uses high frequency ultrasound to supplement his electrodiagnostic studies. He is interested in the use of MSK ultrasound to improved patient education as well as medical student education.



L. Britt Wilson, Ph.D., is an associate professor in the Department of Pharmacology, Physiology and Neuroscience at the University of South Carolina School of Medicine. He received his Ph.D. in physiology from LSU Medical Center in New Orleans and

completed a post-doctoral fellowship at University of Texas Southwestern Medical School. He joined the faculty at the University of South Carolina in 2002 and has served as course director for medical physiology for nine years. Recognized as an outstanding educator, he has been the recipient of the MI Teacher of the Year and the O'Neill Barrett Teaching Excellence Award. He has published more than 40 research and education publications.



R. Eugene Zierler, MD, RPVI, is a professor in the Department of Surgery and Division of Vascular Surgery at the University of Washington School of Medicine where he is also the Medical Director of the D. E. Strandness, Jr. Vascular Laboratory. His

research interests have focused on the development and clinical applications of noninvasive diagnostic techniques for vascular disease. Over the last 25 years, he has been involved in a series of projects based on the use of ultrasonic duplex scanning for screening and follow-up of various vascular problems, including carotid artery disease, lower extremity arterial disease, surveillance of vein bypass grafts, deep vein thrombosis and renal artery disease. He serves on the Board of Directors of the American Registry for Diagnostic Medical Sonography.

Appreciation of other faculty attending:

| | |
|--------------------|-------------------|
| Zubair Chao | James Kreiner |
| Catherine Erickson | Faye Kuperman |
| Robert Haddad | Linda Luther |
| Joyce Holt | Paisith Piriyawat |

WORLD CONGRESS PLANNING COMMITTEE

Tripp Bell
Michael Blaivas
Will Burns
Sarah Cain
Shelley Coburn
Kojo Danquah-Duah
Mechelle English
Stephen Harris
Sarah Harper
Celia Hartman
Richard Hoppmann
Duncan Howe
Judy Johnson
Donald Kenney
Deb Krotish
Gerri Lutes
Luci Neri
Jeff Perkins
Mary Beth Poston
Victor Rao
Shaun Riffle
Ruth Riley
Kate Shelton
Matt Splett
Enrico Storti
Jim Twitty

PARTNERSHIPS AND SUPPORTERS

Special thank you to the following corporations and organizations for their partnership and support of the Second World Congress on Ultrasound in Medical Education.

Gold Level Sponsor

GE Healthcare

Black Level Sponsors

CAE Healthcare

FUJIFILM SonoSite, Inc.

Exhibitors

A-line Press

Academy of Veterinary Imaging by Sound-Eklin

American Institute of Ultrasound in Medicine

American Registry for Diagnostic Medical Sonography

Barnes and Noble

CAE Healthcare

Cook Medical

ESAOTE

FUJIFILM SonoSite, Inc.

GE Healthcare

Gulfcoast Ultrasound Institute

Limbs and Things

Mobisante

Oregon Health & Science University

Primal Pictures

Simbionix USA Corporation

SIMTICS

Society of Ultrasound in Medical Education

SonoSim, INC

Telexy Healthcare

Terason

University of South Carolina School of Medicine

Zonare

Ultrasound for Medical Education

www.gehealthcare.com/pocultrasound



healthymagination

See us at Booth #1



imagination at work

©2013 General Electric Company — All rights reserved.
*Trademark of General Electric Company.



Leading the way in **Ultrasound Education**

University of South Carolina
School of Medicine

www.med.sc.edu



UNIVERSITY OF
SOUTH CAROLINA
School of Medicine



Ultrasound Training Perfected.



CAE Healthcare's VIMEDIX and Blue Phantom
ultrasound simulators deliver training
for more than 20 medical specialties.

VISIT US IN BOOTH 4

www.caehealthcare.com





SONOSITE INTRODUCES THE **FRONTIER PROGRAM** FOR MEDICAL EDUCATION

Visit booth 3 to learn more
about the program.



FUJIFILM SonoSite, Inc. the SonoSite logo and other trademarks not owned by third parties are registered and unregistered trademarks of FUJIFILM SonoSite, Inc. in various jurisdictions. All other trademarks are the property of their respective owners.
©2013 FUJIFILM SonoSite, Inc. All rights reserved. MKT02547 8/13

sonosite.com

THIRD ANNUAL
WORLD CONGRESS
ULTRASOUND IN MEDICAL EDUCATION

**Join us next year in
Portland, Oregon
Oct. 10-12, 2014**

At Oregon Health & Science University, host of next year's World Congress of Ultrasound in Medical Education, big ideas come in all shapes and sizes. The biggest and best have one thing in common — they change the landscape of health.

We hope you will join us in Portland, Oregon, in 2014 to learn about the next big ideas in ultrasound and their impact on training future health care professionals.

**For more information contact
events@ohsu.edu or call 503-494-4156.**



BE SURE TO STOP BY THE EXHIBIT HALL EACH DAY!

Continental breakfast, refreshment breaks, and lunch is served in the Exhibit Hall.

Please present your lunch ticket on Friday and Saturday.

EXHIBIT HALL SCHEDULE

Friday, September 27
7:30 AM - 5:30 PM

Saturday, September 28
7:15 AM - 3:30 PM



CONVENTION CENTER FLOOR PLAN

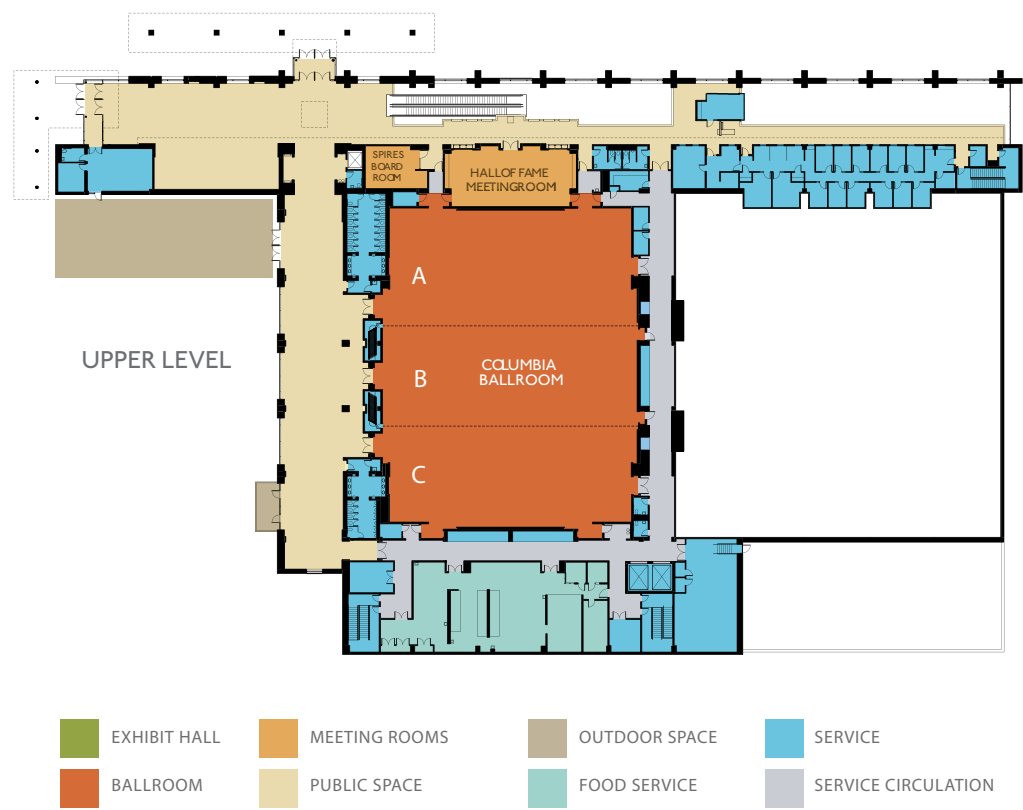
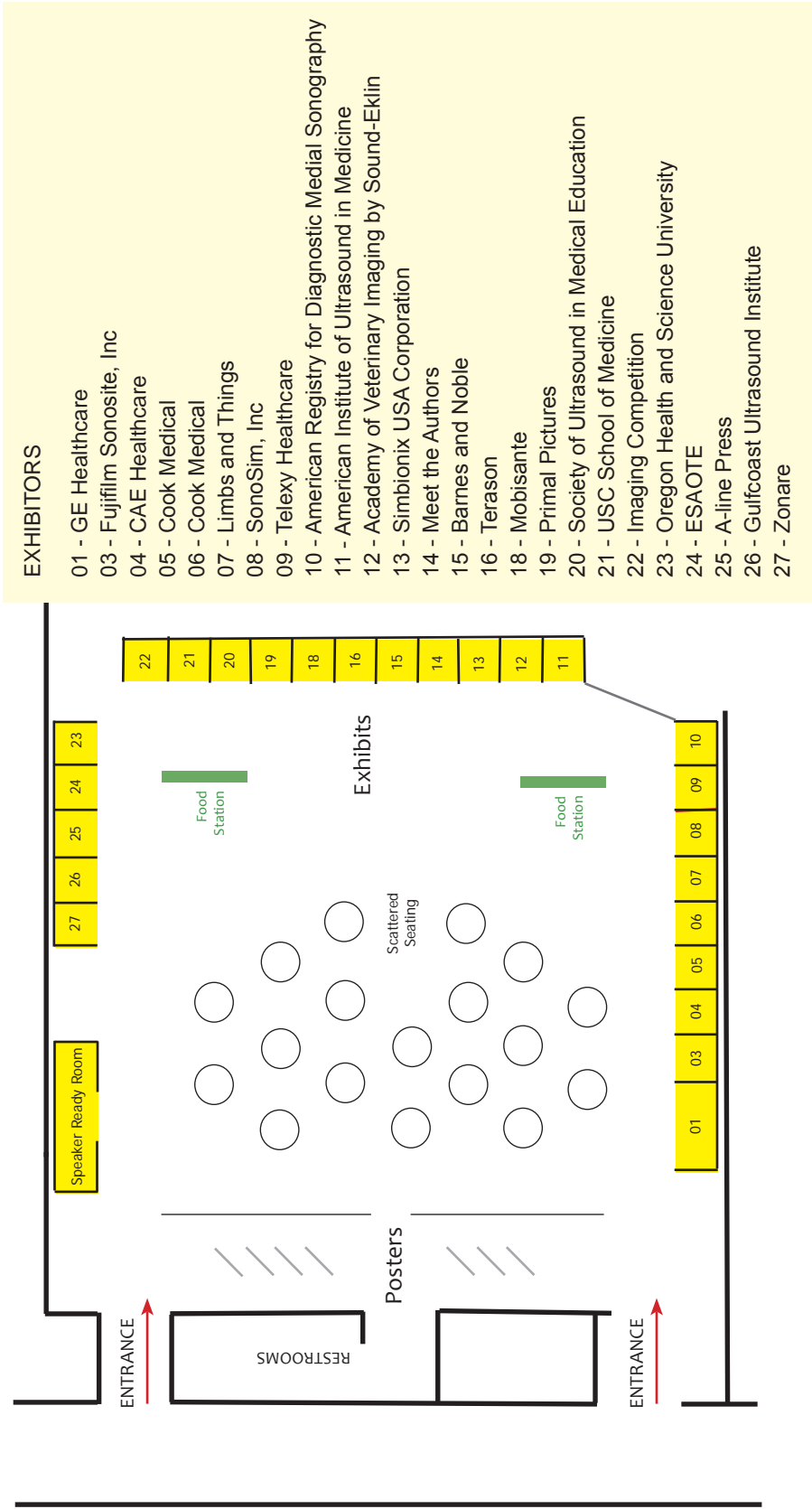



EXHIBIT HALL BOOTHS AND LAYOUT

Exhibit Hall

Columbia Metropolitan Convention Center





MAP OF DOWNTOWN COLUMBIA

regions

- COLUMBIA CITY CENTER
- COLUMBIA NORTH
- COLUMBIA SE & FT JACKSON
- IRMO - ST ANDREWS & HARBISON
- LEXINGTON COUNTY
- RICHLAND NE & FT JACKSON
- WEST COLUMBIA/CAJCE & AIRPORT

attractions | shopping districts

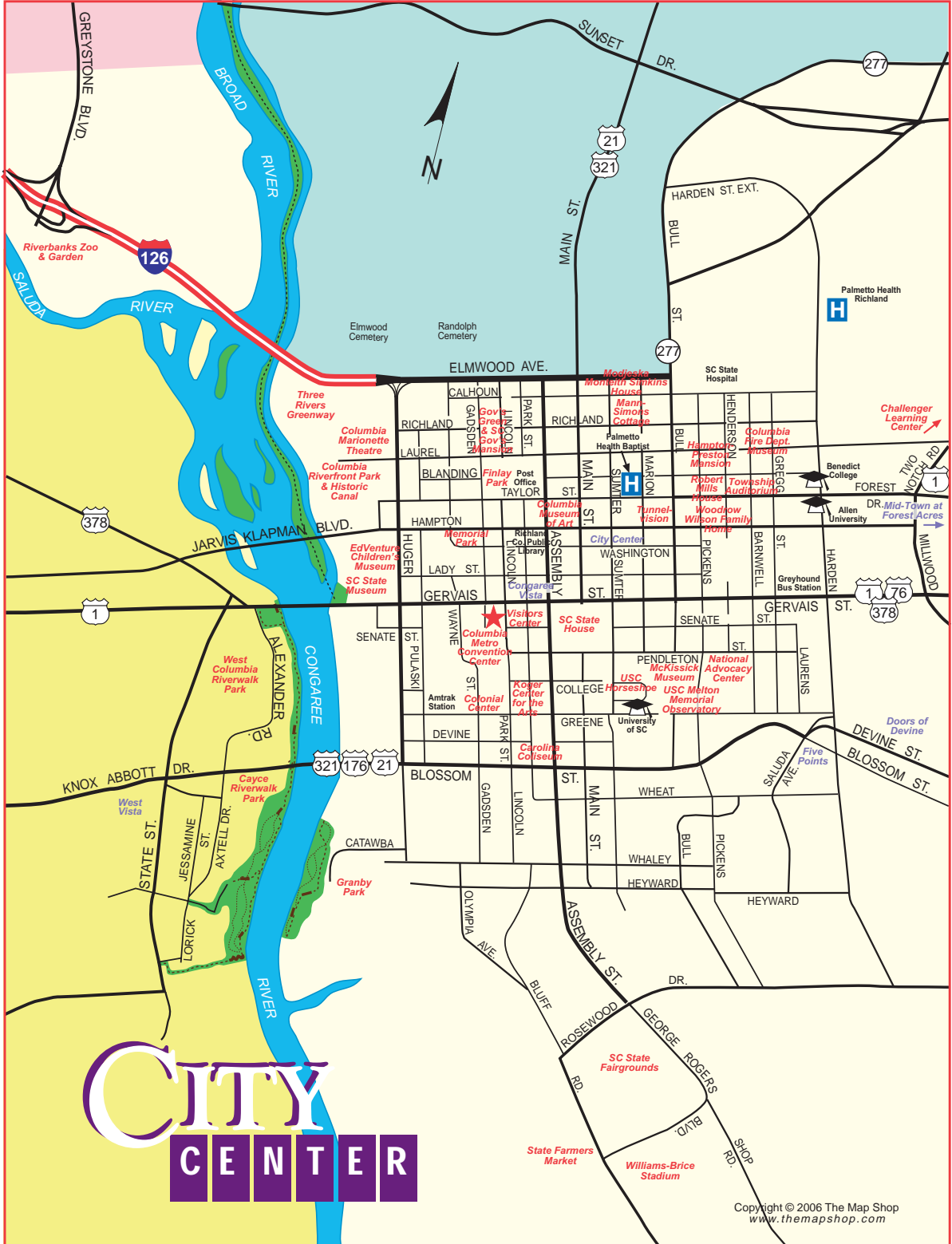

Copyright © 2006 The Map Shop
www.themapshop.com

FREE WIFI ACCESS

For the convenience of our guest, we welcome you to enjoy Free Wireless Access throughout the Convention Center.

- (2Mbps bandwidth shared among ALL free wireless users)
- Hotspot wireless SSID = CMCC_Hotspot
- Guest access login is required
- For Guest access, please use your complete E-mail address (ex.: johndoe@mycompany.com)
- Log-in instruction - Open your browser with an 802.11a/b/g/n compliant device and you will see the log in screen shown below. If your device does not automatically redirect to the screen below, manually insert <https://bluesocket.columbiacvb.com/login.pl> into your address bar. ****Fill in the appropriate YELLOW box (Don't forget to check the 'I accept terms...' box) Then click on 'Log In'.** Please see screen shot below.



**Welcome to the
Columbia Metropolitan Convention Center**

We are please to provide you with Internet services. **Please note:** The Columbia Metropolitan Convention Center does not assume responsibility for any malicious computer-based attacks while using this service. If you accept this disclaimer, please continue to login. To login as a guest, simply enter your email address in the "Guests" login area and click the "Log In" button. This will provide you with limited access to Internet based services. For upgraded access to Internet Services, please contact your Event Coordinator.

Thank You

Visit - Learn - Explore
COLUMBIA, SOUTH CAROLINA

Schedule At-A-Glance

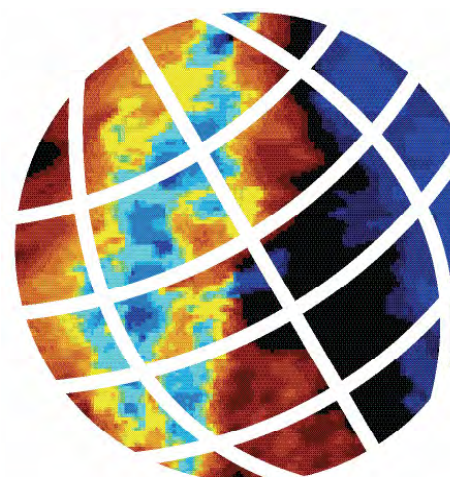

Friday, September 27

- 7:30 A.M. – 5:30 P.M.
 - 7:30 A.M. – 5:30 P.M.
 - 7:30 – 8:30 A.M.
 - 8:00 – 8:30 A.M.
 - 8:30 – 10:00 A.M.
 - 10:00 – 10:30 A.M.
 - 10:30 A.M. – 12:00 P.M.
 - 12:00 – 1:30 P.M.
 - 1:30 – 3:00 P.M.
 - 3:00 – 3:30 P.M.
 - 3:30 – 5:00 P.M.
 - 7:00 – 9:00 P.M.
- Registration Open
Exhibit Hall Open
Continental Breakfast; *Lobby of Columbia Ballroom A and Exhibit Hall*
Welcome
Plenary Session 1
Break in the Exhibit Hall
Plenary Session 2
Lunch and Poster Session 1; *Exhibit Hall*
Concurrent Sessions 1 and 2
Abstract Sessions 1 and 2
Workshops 1-5
Break in the Exhibit Hall
Concurrent Session 3
Abstract Sessions 3 and 4
Workshops 6-11
Welcome Reception at Columbia Museum of Art

Saturday, September 28

- 7:15 – 8:30 A.M.
 - 7:15 – 8:15 A.M.
 - 7:15 – 8:15 A.M.
 - 7:15 A.M. – 3:30 P.M.
 - 7:30 A.M. – 5:00 P.M.
 - 8:15 – 8:30 A.M.
 - 8:30 – 10:00 A.M.
 - 10:00 – 10:30 A.M.
 - 10:30 A.M. – 12:00 P.M.
 - 12:00 – 1:30 P.M.
 - 1:30 – 3:00 P.M.
 - 3:00 – 3:30 P.M.
 - 3:30 – 5:00 P.M.
 - 4:30 – 6:30 P.M.
 - 7:00 – 9:00 P.M.
- Continental Breakfast in Lobby of Columbia Ballroom A and Exhibit Hall
Interest Group Breakfast
SUSME Board Meeting
Exhibit Hall Open
Registration Open
Welcome
Plenary Session 3
Break in the Exhibit Hall
Plenary Session 4
Lunch and Poster Session 2 in the Exhibit Hall
Concurrent Sessions 4 and 5
Abstract Sessions 5 and 6
Workshops 1-5
Break in the Exhibit Hall
Concurrent Sessions 6 and 7
Abstract Sessions 7 and 8
Workshops 6-10
WINFOCUS Board Meeting
BBQ at the Zoo Event at Riverbanks Zoo and Garden

Sunday, September 29

- 7:30 – 8:00 A.M.
 - 7:30 – 11:30 A.M.
 - 8:00 – 8:15 A.M.
 - 8:15 – 9:30 A.M.
 - 9:30 – 9:45 A.M.
 - 9:45 – 11:15 A.M.
 - 11:15 – 11:30 A.M.
 - 11:30 A.M. – 1:00 P.M.
- Coffee in Lobby of Columbia Ballroom A
Registration in the Upper Level
Welcome
Plenary Session 5
Break
Concurrent Session 8
Abstract Sessions 9 and 10
Workshops 1-5
Break
Workshops 6-10

SECOND WORLD CONGRESS
ULTRASOUND IN MEDICAL EDUCATION
SEPTEMBER 27 - 29, 2013



Brought to you by the Society of Ultrasound in Medical Education and WINFOCUS
Hosted by the University of South Carolina School of Medicine